



**Alaska District
U.S. Army Corps of Engineers**

Operations Branch **Public Notice**

Issue Date: March 1, 2019 Expiration Date: March 15, 2019
Identification No. 408-POA-2019-0001
Please refer to the identification number when replying.

Section 408 Review Skagway River Levee (West Bank) Skagway, Alaska

The Alaska District (District) of the U. S. Army Corps of Engineers (USACE) has received a request pursuant to Section 14 of the Rivers and Harbors Act of 1899, 33 U.S.C. 408 (Section 408), from PND Engineers, Inc. acting on behalf of the Municipality of Skagway. The proposed project consists of placing a new levee along the west bank of the Skagway River that would be tied into the Klondike Highway Bridge abutment and extend approximately 500 feet downstream as shown in the enclosed project drawings.

The proposed project could potentially alter a federally authorized training dike and breakwater constructed on the east bank of the Skagway River and therefore requires authorization from USACE. Section 408 provides authority to the Secretary of the Army, on the recommendation of the Chief of Engineers, to grant permission for the alteration of USACE civil works projects when the activity will not be injurious to the public interest and will not impair the usefulness of the federal project. USACE policy and procedural guidance for processing Section 408 requests are outlined in Engineer Circular 1165-2-220.

This public notice announces the Section 408 review and requests that interested parties submit, in writing, any comments directed specifically to this review. Comments will be part of the record and considered in determining whether it would be in the public interest to proceed with this action. Comments must refer to the identification number above, be postmarked by the public notice expiration date, and sent to the following address:

U.S. Army Corps of Engineers, Alaska District
CEPOA-EC-O
PO Box 6898
JBER, AK 99506-0898

For more information about the proposed project or to submit comments electronically, please email Michael Tencza, District Section 408 Coordinator, at Michael.G.Tencza@usace.army.mil.



SKAGWAY RIVER

SKAGWAY, ALASKA



US Army Corps of Engineers Alaska District

NOTES:

1. THIS LOCALITY IS SHOWN ON USGS QUAD SKAGWAY B-1
2. CURRENT SURVEY INFORMATION FOR THIS PROJECT AT www.poa.usace.army.mil/About/Offices/ConstructionOperations/RiversandHarbors.aspx

MAP DATE: 2016OCT IMAGERY DATE: 2016MAY14

Imagery Credits: National Geographic, ESRI, DeLorme, NAVTEQ, UNEP-WCMC, USGS, NASA, METI, NRCAN, GEBCO, NOAA, IPC, DigitalGlobe, GeoEye, Earthstar Geographics, SIO

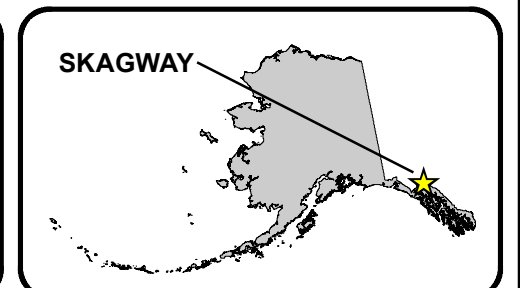
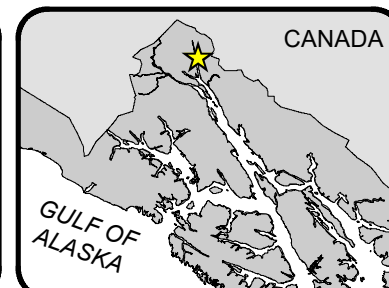

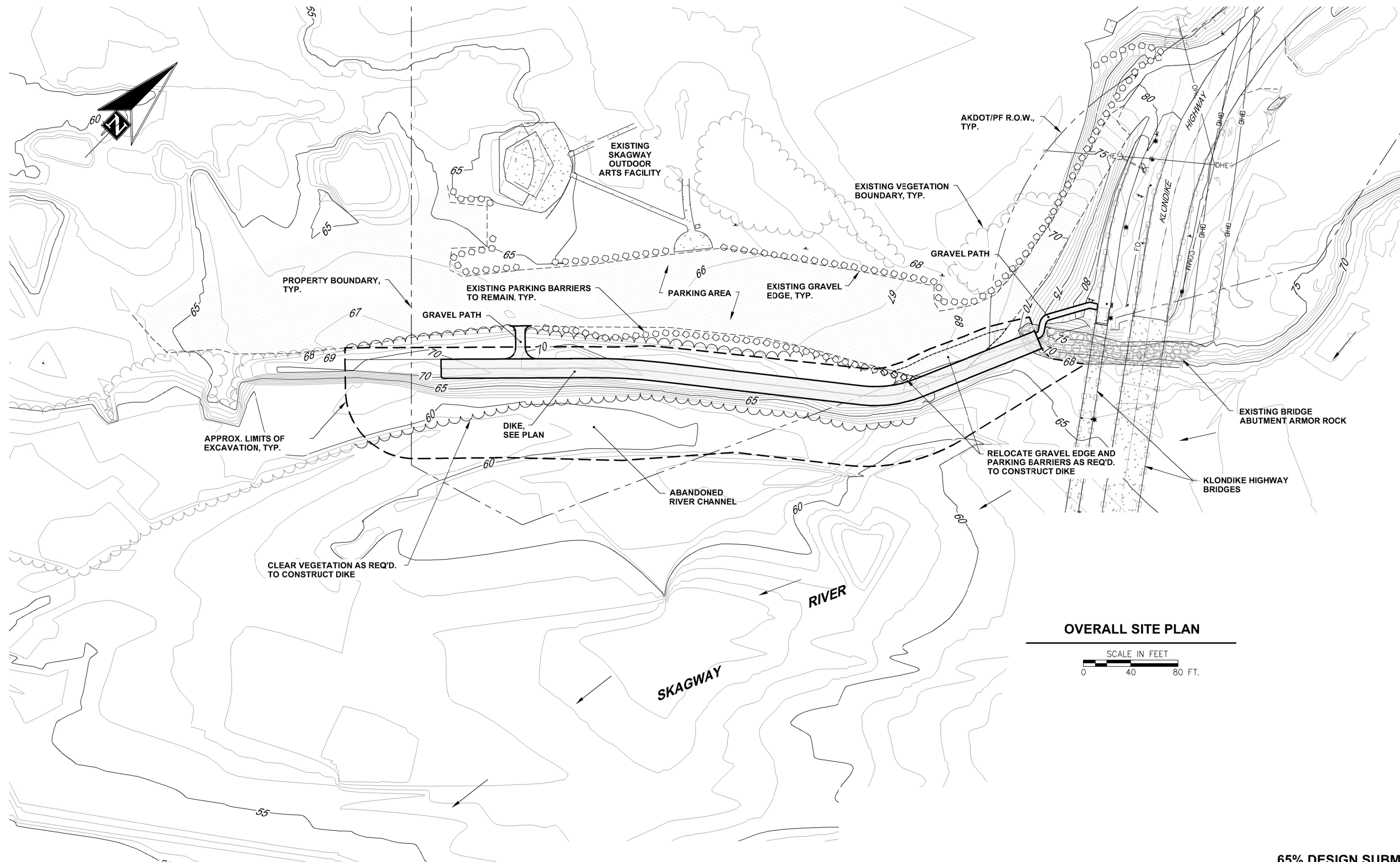

OVERALL SITE PLAN

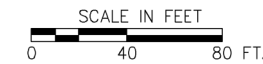

65% DESIGN SUBMITTAL



REVISIONS					
REV.	DATE	DESCRIPTION	DWN.	CKD.	APP.

P | N | D
ENGINEERS, INC.

9360 Glacier Highway Ste 100
Juneau, Alaska 99801
Phone: 907-586-2093
Fax: 907-586-2099
www.pndengineers.com

DESIGN: CRS
DRAWN: PJD

CHECKED: CRS
APPROVED: CRS

SCALE:
AS SHOWN



MUNICIPALITY OF SKAGWAY, ALASKA
SKAGWAY RIVER EROSION CONTROL

SHEET TITLE:
OVERALL SITE PLAN

PND PROJECT NO.: 152060.01

1.03
SHEET
3 OF 9

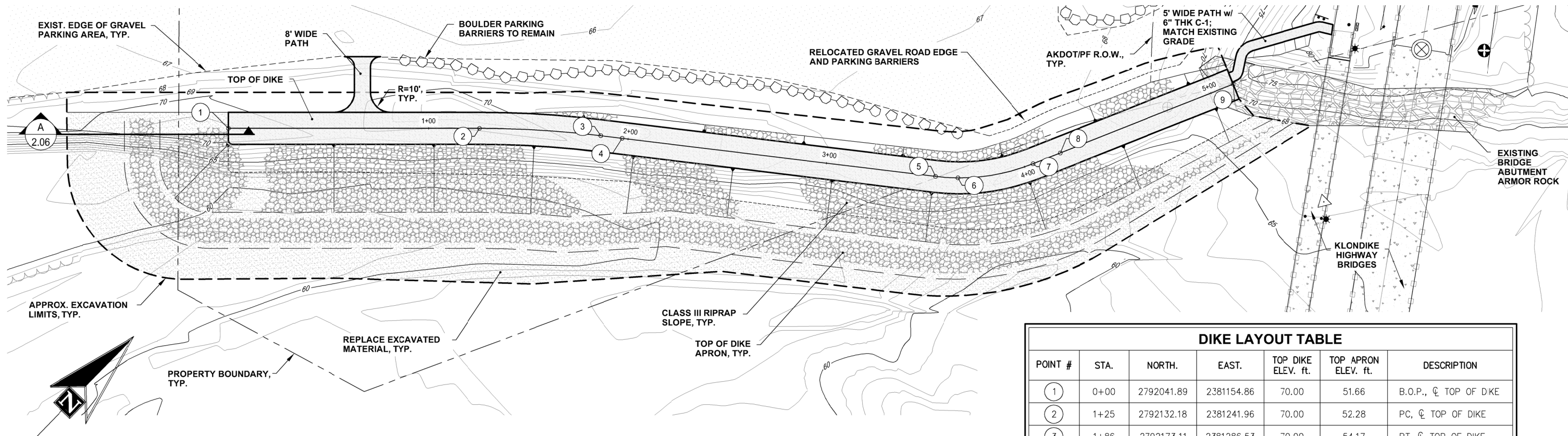

DIKE ESTIMATED VOLUMES (CUBIC YARDS)				
EXCAVATION (CY)	RIPRAP (CY)	FILTER ROCK (CY)	FILL (CY)	BASE COURSE (CY)
8,000	4,000	1,000	600	165

DIKE LAYOUT TABLE						
POINT #	STA.	NORTH.	EAST.	TOP DIKE ELEV. ft.	TOP APRON ELEV. ft.	DESCRIPTION
1	0+00	2792041.89	2381154.86	70.00	51.66	B.O.P., CL TOP OF DIKE
2	1+25	2792132.18	2381241.96	70.00	52.28	PC, CL TOP OF DIKE
3	1+86	2792173.11	2381286.53	70.00	54.17	PT, CL TOP OF DIKE
4	1+97	2792180.03	2381295.05	70.00	54.73	GB, CL TOP OF DIKE
5	3+55	2792279.39	2381417.35	70.37	57.93	PC, CL TOP OF DIKE
6	3+66	2792287.12	2381425.81	70.40	58.19	GB, CL TOP OF DIKE
7	4+05	2792319.08	2381446.82	71.72	59.13	PT, CL TOP OF DIKE
8	4+19	2792332.49	2381452.32	72.20	59.46	GB, CL TOP OF DIKE
9	5+12	2792418.66	2381487.64	72.20	59.61	E.P., CL TOP OF DIKE

B.O.P. = BEGINNING OF PROJECT GB = GRADE BREAK
CL = CENTERLINE E.P. = END OF PROJECT

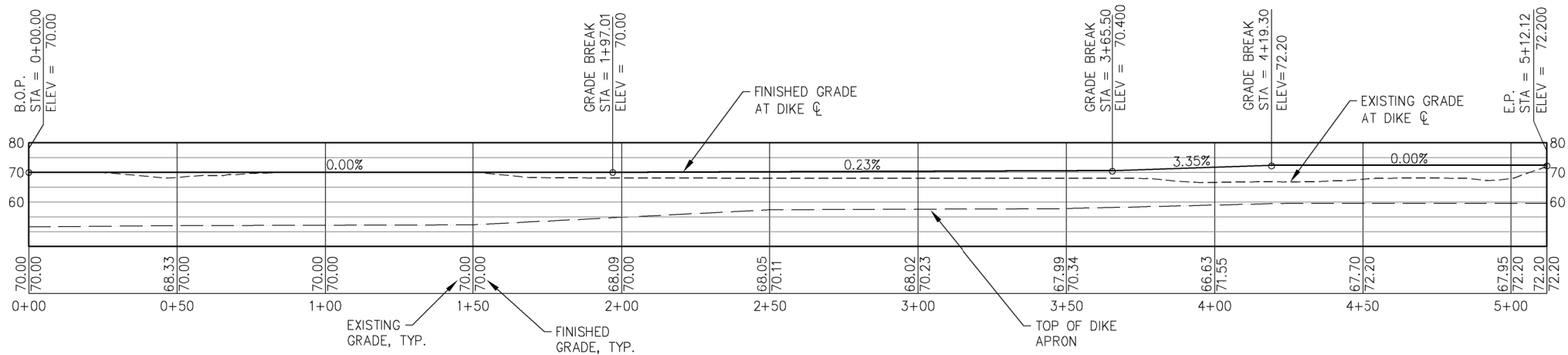

DIKE PROFILE

65% DESIGN SUBMITTAL



REVISIONS				
REV.	DATE	DESCRIPTION	DWN.	CKD.



9360 Glacier Highway Ste 100
Juneau, Alaska 99801
Phone: 907-586-2093
Fax: 907-586-2099
www.pndengineers.com

DESIGN: CRS CHECKED: CRS
DRAWN: PJD APPROVED: CRS

SCALE:
AS SHOWN



MUNICIPALITY OF SKAGWAY, ALASKA
SKAGWAY RIVER EROSION CONTROL

SHEET TITLE:
DIKE SITE PLAN AND PROFILE
WITH LAYOUT TABLE

PND PROJECT NO.: 152060.01

2.01
SHEET
4 OF 9

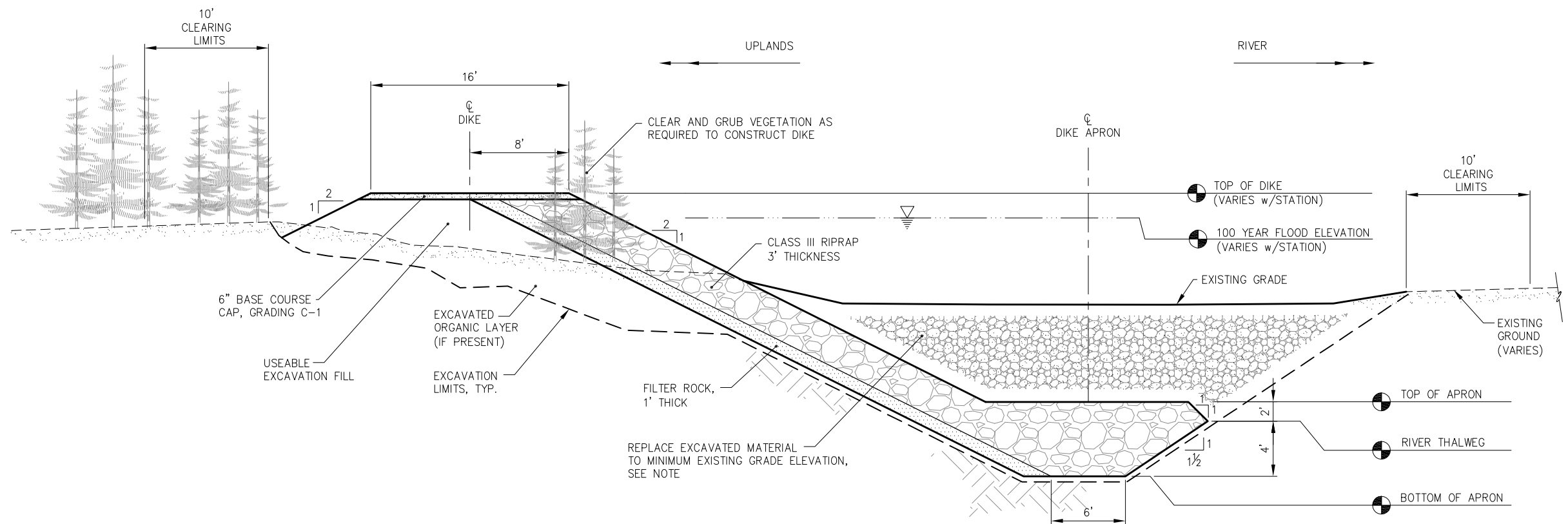

TYPICAL DIKE SECTION

NOTE:
DISPOSE SURPLUS EXCAVATION IN RIVER BED ALONG
DIKE SLOPES. GRADE TO DRAIN AWAY FROM DIKE.

MATERIAL GRADATIONS

CLASS III RIPRAP:

50-100% WEIGHING 950 POUNDS OR MORE
0-15% WEIGHING MORE THAN 2100 POUNDS
0-5% WEIGHING LESS THAN 115 POUNDS

FILTER ROCK:

FILTER ROCK SHALL CONSIST OF BLASTED, ANGULAR SHOT ROCK BETWEEN 4" AND 10" IN DIAMETER, WITH 10% MAXIMUM SMALLER THAN 4", AND 3% MAXIMUM SMALLER THAN #200 SIEVE.

BASE COURSE:

BASE COURSE, GRADING C-1 AS SPECIFIED IN ALASKA DOT & PF STANDARD SPECIFICATIONS FOR HIGHWAY CONSTRUCTION, 2015 EDITION.

USEABLE EXCAVATION FILL:

USEABLE EXCAVATION FILL SHALL CONSIST OF NON FROST SUSCEPTIBLE (N.F.S.) SANDS AND GRAVELS. EXCAVATED MATERIALS FROM THE SKAGWAY RIVER MAY BE ACCEPTABLE FOR USE AS EMBANKMENT FILL UPON ENGINEER'S APPROVAL.

65% DESIGN SUBMITTAL



REVISIONS					
REV.	DATE	DESCRIPTION	DWN.	CKD.	APP.

P**N****D**

ENGINEERS, INC.

9360 Glacier Highway Ste 100
Juneau, Alaska 99801
Phone: 907-586-2093
Fax: 907-586-2099
www.pndengineers.com

DESIGN: CRS
DRAWN: PJD
CHECKED: CRS
APPROVED: CRS

SCALE: SCALE IN FEET
0 10 20 FT.

STATE OF ALASKA
49TH

Charles R. Somerville
CE-8845
REGISTERED PROFESSIONAL ENGINEER

DATE: JAN. 25, 2017

MUNICIPALITY OF SKAGWAY, ALASKA
SKAGWAY RIVER EROSION CONTROL

SHEET TITLE: TYPICAL DIKE SECTION WITH MATERIAL SUMMARY
PND PROJECT NO.: 152060.01

2.02
SHEET 5 OF 9

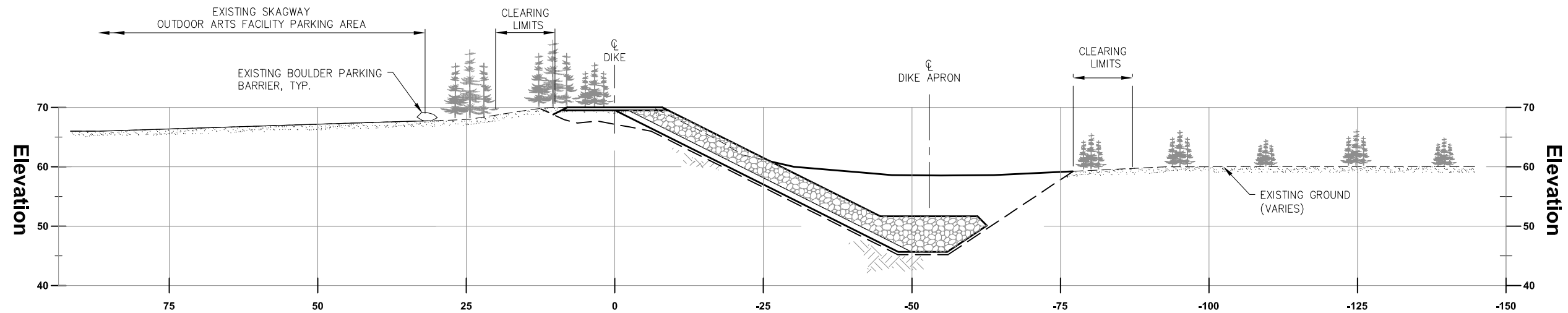

DIKE SECTION - STATION 0+00

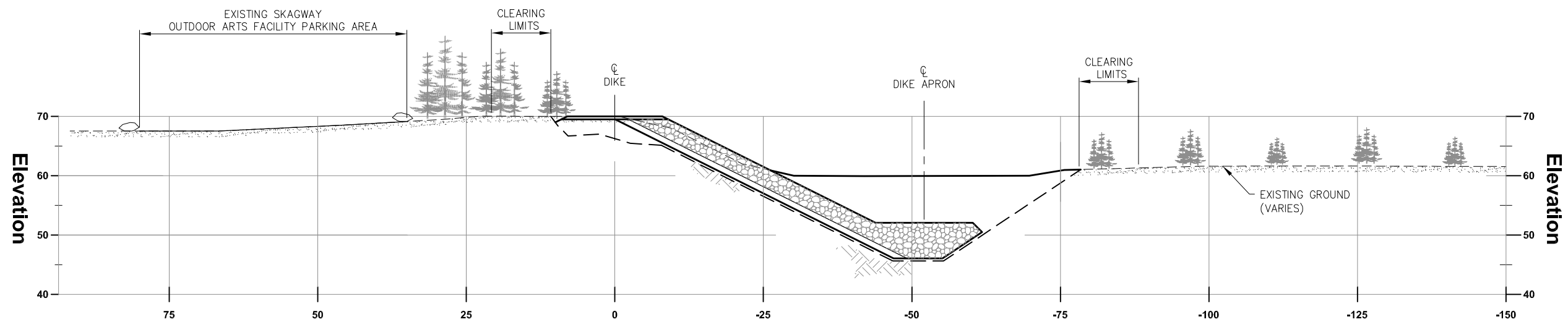

DIKE SECTION - STATION 0+50

65% DESIGN SUBMITTAL



REVISIONS					
REV.	DATE	DESCRIPTION	DWN.	CKD.	APP.



ENGINEERS, INC.

9360 Glacier Highway Ste 100
Juneau, Alaska 99801
Phone: 907-586-2093
Fax: 907-586-2099
www.pndengineers.com

DESIGN: CRS CHECKED: CRS
DRAWN: PJD APPROVED: CRS

SCALE: SCALE IN FEET
0 10 20 FT.

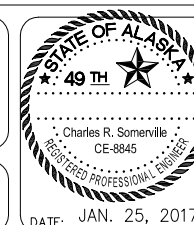

MUNICIPALITY OF SKAGWAY, ALASKA
SKAGWAY RIVER EROSION CONTROL

SHEET TITLE: DIKE SECTIONS:
STA. 0+00 AND STA. 0+50

PND PROJECT NO: 152060.01

2.03

SHEET
6 OF 9

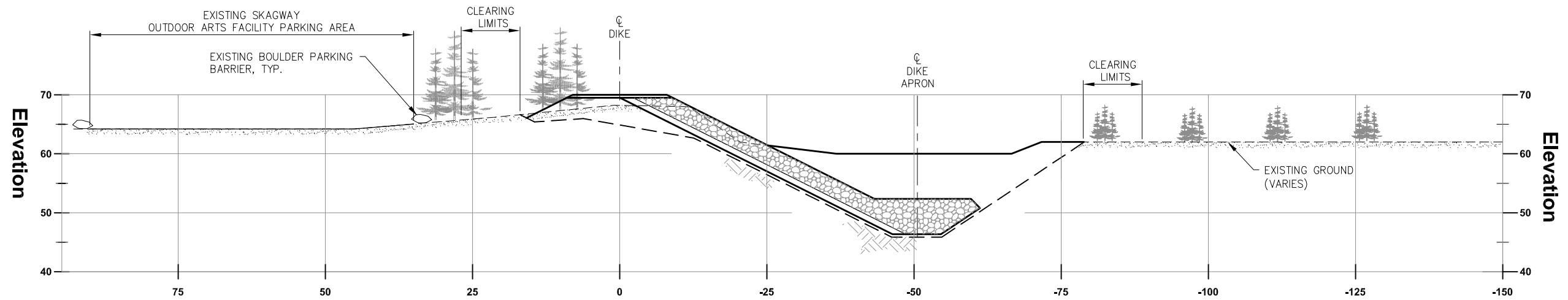

DIKE SECTION - STATION 1+50

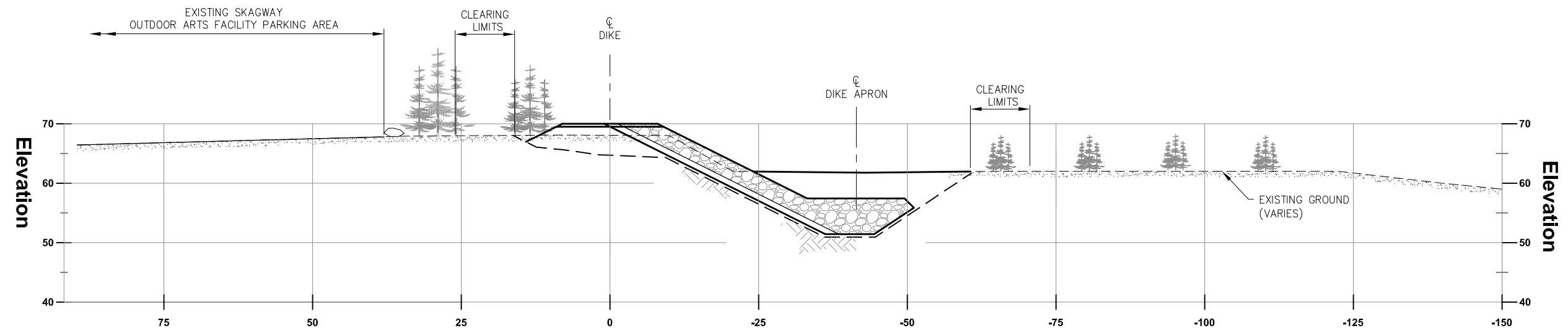

DIKE SECTION - STATION 2+50

65% DESIGN SUBMITTAL



REVISIONS					
REV.	DATE	DESCRIPTION	DWN.	CKD.	APP.

P | N | D
ENGINEERS, INC.

9360 Glacier Highway Ste 100
Juneau, Alaska 99801
Phone: 907-586-2093
Fax: 907-586-2099
www.pndengineers.com

DESIGN: CRS CHECKED: CRS
DRAWN: PJD APPROVED: CRS

SCALE:



MUNICIPALITY OF SKAGWAY, ALASKA
SKAGWAY RIVER EROSION CONTROL

SHEET TITLE: **DIKE SECTIONS:
STA. 1+50 AND STA. 2+50**

PND PROJECT NO.: 152060.01

2.04

SHEET
7 OF 9

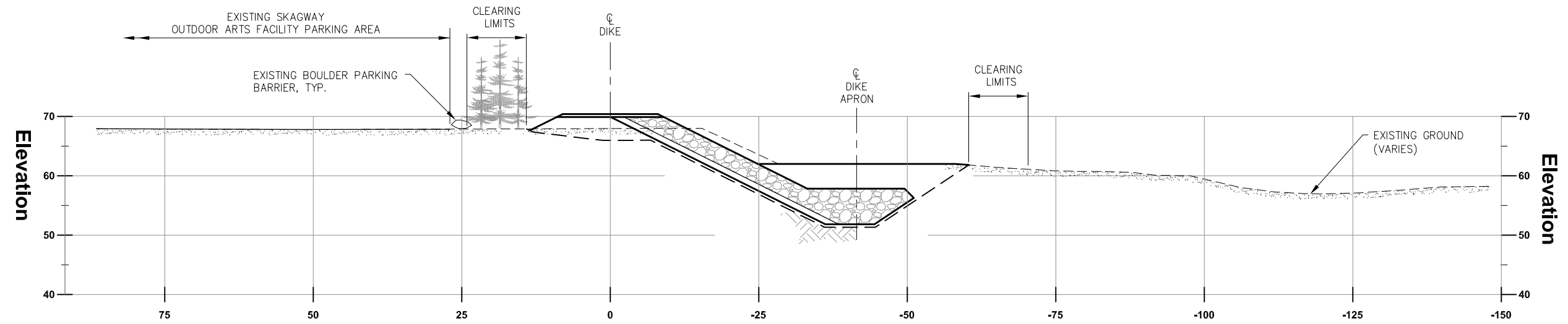

DIKE SECTION - STATION 3+50

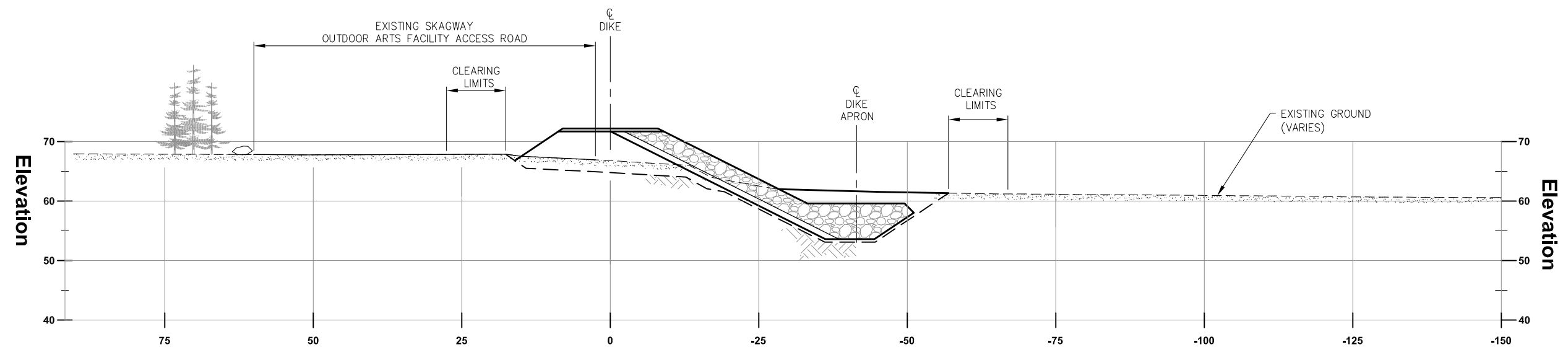

DIKE SECTION - STATION 4+25

65% DESIGN SUBMITTAL



REVISIONS					
REV.	DATE	DESCRIPTION	DWN.	CKD.	APP.



ENGINEERS, INC.

9360 Glacier Highway Ste 100
Juneau, Alaska 99801
Phone: 907-586-2093
Fax: 907-586-2099
www.pndengineers.com

DESIGN: CRS CHECKED: CRS
DRAWN: PJD APPROVED: CRS

SCALE:

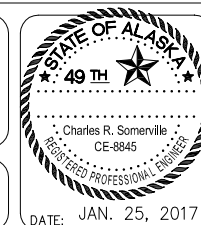

MUNICIPALITY OF SKAGWAY, ALASKA
SKAGWAY RIVER EROSION CONTROL

SHEET TITLE: **DIKE SECTIONS:
STA. 3+50 AND STA. 4+25**

PND PROJECT NO.: 152060.01

2.05

SHEET
8 OF 9

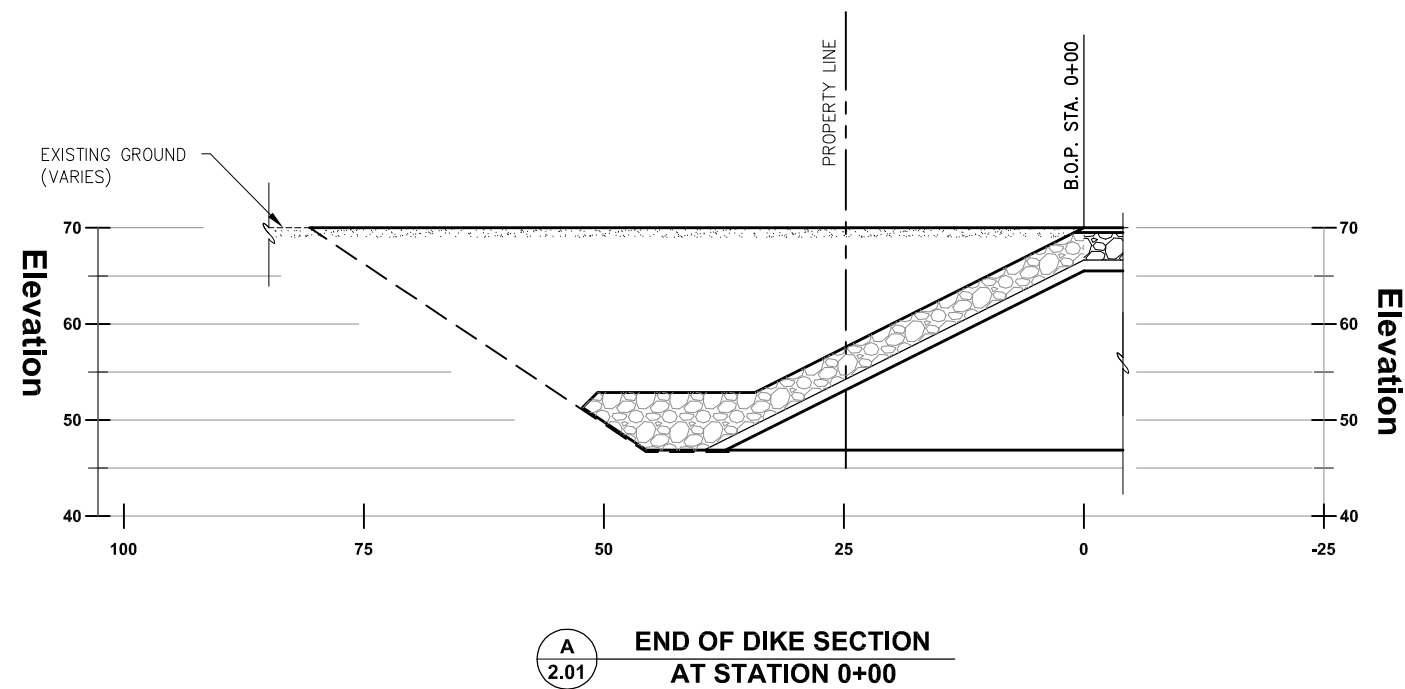
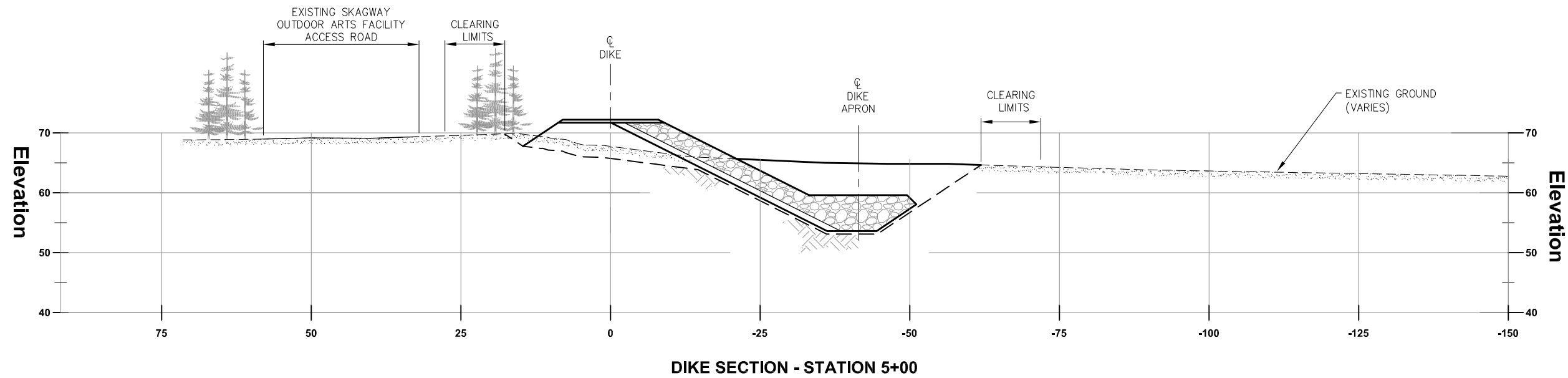

65% DESIGN SUBMITTAL



REVISIONS					
REV.	DATE	DESCRIPTION	DWN.	CKD.	APP.



ENGINEERS, INC.

9360 Glacier Highway Ste 100
Juneau, Alaska 99801
Phone: 907-586-2093
Fax: 907-586-2099
www.pndengineers.com

DESIGN: CRS CHECKED: CRS
DRAWN: PJD APPROVED: CRS

SCALE: SCALE IN FEET
0 10 20 FT.

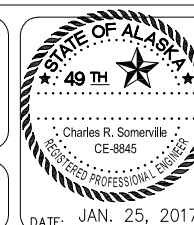

**MUNICIPALITY OF SKAGWAY, ALASKA
SKAGWAY RIVER EROSION CONTROL**

SHEET TITLE: **DIKE SECTIONS:
STA. 5+00 AND END OF DIKE**

PND PROJECT NO.: 152060.01

2.06
SHEET
9 OF 9