

DRY LAND APPROVED JURISDICTIONAL DETERMINATION FORM¹
U.S. Army Corps of Engineers

This form should be completed by following the instructions provided in Section IV of the JD Form Instructional Guidebook.

SECTION I: BACKGROUND INFORMATION

A. REPORT COMPLETION DATE FOR APPROVED JURISDICTIONAL DETERMINATION (JD): *May 17, 2023*

B. DISTRICT OFFICE, FILE NAME, AND NUMBER: *Alaska District, NANA construction Office building, Chukchi Sea, POA-2023-00230*

C. PROJECT LOCATION AND BACKGROUND INFORMATION:

State: Alaska County/parish/borough: Northwest Arctic City: Kivalina
Center coordinates of site (lat/long in degree decimal format): Lat. 67.72698 °, Long. -164.54009 °
Name of nearest waterbody: Chukchi Sea
Name of watershed or Hydrologic Unit Code (HUC): 190504041308

- Check if map/diagram of review area is available upon request.
 Check if other sites (e.g., offsite mitigation sites, disposal sites, etc...) are associated with this action and are recorded on a different JD form.

D. REVIEW PERFORMED FOR SITE EVALUATION (CHECK ALL THAT APPLY):

- Office (Desk) Determination. Date: *May 3, 2023*
 Field Determination. Date(s): *Click here to enter a date.*

SECTION II: SUMMARY OF FINDINGS

A. RHA SECTION 10 DETERMINATION OF JURISDICTION.

There **are no** "navigable waters of the U.S." within Rivers and Harbors Act (RHA) jurisdiction (as defined by 33 CFR part 329) in the review area.

B. CWA SECTION 404 DETERMINATION OF JURISDICTION.

There **are no** "waters of the U.S." within Clean Water Act (CWA) jurisdiction (as defined by 33 CFR part 328) in the review area.

SECTION III: DATA SOURCES.

A. SUPPORTING DATA. Data reviewed for JD (check all that apply - checked items shall be included in case file and, where checked and requested, appropriately reference sources below):

- Maps, plans, plots or plat submitted by or on behalf of the applicant/consultant:
 Data sheets prepared/submitted by or on behalf of the applicant/consultant.
 Office concurs with data sheets/delineation report.
 Office does not concur with data sheets/delineation report.
 Data sheets prepared by the Corps: *Click here to enter text.*
 U.S. Geological Survey Hydrologic Atlas: National Regulatory Viewer
 USGS NHD data.
 USGS 8 and 12 digit HUC maps.
 U.S. Geological Survey map(s). Cite scale & quad name: *Online Map Viewer*
 USDA Natural Resources Conservation Service Soil Survey. Citation: *No available information to review for the area in question.*
 National wetlands inventory map(s). Cite name: *Click here to enter text.*
 State/Local wetland inventory map(s): *Click here to enter text.*
 FEMA/FIRM maps: *Click here to enter text.*
 100-year Floodplain Elevation is: *Click here to enter text.* (National Geodetic Vertical Datum of 1929)
 Photographs: Aerial (Name & Date): *Click here to enter text.*
 or Other (Name & Date): *Click here to enter text.*
 Previous determination(s). File no. and date of response letter: *Click here to enter text.*
 Applicable/supporting case law: *Click here to enter text.*
 Applicable/supporting scientific literature: *Click here to enter text.*
 Other information (please specify): *POA Mapper, Google Earth Historical images; 2007: Section 117 Expedited Erosion Control Project - Kivalina, Alaska -EA & FONSI (USACE)*

¹ This form is for use only in recording approved JDs involving dry land. It extracts the relevant elements of the longer approved JD form in use since 2007 for aquatic areas and adds no new fields.

B. REQUIRED ADDITIONAL COMMENTS TO SUPPORT JD. EXPLAIN RATIONALE FOR DETERMINATION THAT THE REVIEW AREA ONLY INCLUDES DRY LAND: Upon review of the submitted project plans and resources cited above it appears that the area seems to be primarily beachgrass (*L.mollis*), a facultative plant, with good drainage and sandy soils. A review of historical imagery failed to show any visible ponding, even in the presence of high precipitation. The village is also raised up from the surrounding beach. As such, the project area does not meet the three wetland criteria of vegetation, soils and hydrology. Based on the available information, the subject review area does not appear to contain waters of the U.S., including wetlands, under the Corps of Engineers jurisdiction.



05/23/2023

Sean O'Donnell
Regulatory Specialist
North Section

Date

Community Map KIVALINA

67° 43' 47" N 164° 32' 45" W (NAD 83)
Approximate Elevation: 15'
Township 27 North, Range 26 West, Kateel River Meridian, AK
U.S.G.S. Quadrangle "NOATAK C-5, D-5, & D-6", Alaska
KOTZEBUE RECORDING DISTRICT

LEGEND

- Residential Building
- Commercial Building
- Public Building
- Basis of Coordinates
- Erosion Area
- Boat Parking
- AMNWR Boundary
- Water Line
- Sewer Line
- Sewer Force Main
- Electric
- Telephone
- Underground Electric
- Underground Telephone
- Electric & Telephone
- Fuel Line
- Edge of Water

SCALE: 1"=100'
Date of Photography: June 12, 2013
Magnetic Declination computed by U.S.G.S. Geomag
Program using IGRP10.COF model as of August 1, 2013



AREA MAP INSET

1"=2640'

Plot No.	Lot	Blk	Deed Type	Owner	Book	Page	Date
89-4	9B & 9C	2	Trustee Deed	NANA Regional Housing Authority	23	450	5/24/1982
2000-6	1A	9	Lease Agreement	Northwest Inupiat Housing Authority	56	759-769	8/18/2000
2000-6	1B	9	Trustee Deed	City of Kivalina	34	605-606	10/19/1988
2000-6	1A & 1B	10	Lease Agreement	Northwest Inupiat Housing Authority	56	759-769	8/18/2000
2000-6	1C	10	Trustee Deed	City of Kivalina	34	609-610	10/19/1988
2001-13	4A & 4B	5	Trustee Deed	NANA Regional Housing Authority	23	452	5/24/1982
2009-9	1A	6	Patent	NANA Regional Corporation Inc	25	831-832	10/31/1983
2009-9	2A	6	Trustee Deed	City of Kivalina	34	597-598	10/19/1988

Lot	Blk	Deed Type	Owner	Book	Page	Date
1	1	Trustee Deed	City of Kivalina	34	587-588	10/19/1988
2 & 3	1	Lease	Kivalina IRA Council	44	25-29	5/15/1995
1	2	Trustee Deed	City of Kivalina	34	591-592	10/19/1988
1	3	Trustee Deed	Native Village of Kivalina	32	584-585	3/27/1987
1	4	Trustee Deed	City of Kivalina	34	593-594	10/19/1988
3	4	Trustee Deed	Kivalina Friends Church	34	624-625	10/25/1988
1	5	Trustee Deed	City of Kivalina	34	595-596	10/19/1988
4	7	Trustee Deed	City of Kivalina	34	599-600	10/19/1988
1	8	Trustee Deed	City of Kivalina	23	219	3/24/1982
SW 3	8	Trustee Deed	Alaska Village Electric Cooperative Inc	29	799	11/22/1985
NE 3	8	Trustee Deed	City of Kivalina	34	632-633	10/27/1988
4	8	Trustee Deed	Epiphany Episcopal Church of Kivalina	34	626-627	10/25/1988
6	8	Trustee Deed	City of Kivalina	34	601-602	10/19/1988
7	8	Trustee Deed	City of Kivalina	25	312	7/08/1983
8	8	Trustee Deed	City of Kivalina	34	603-604	10/19/1988
4 & 7	9	Lease Agreement	Northwest Inupiat Housing Authority	56	759-769	8/18/2000
3	10	Trustee Deed	NANA Regional Housing Authority	23	457	5/24/1982
5	12	Quit Claim Deed	Alaska Yearly Meeting of Friends	36	145-146	8/11/1989
6	12	Quit Claim Deed	Kivalina Epiphany Church	36	143-144	8/11/1989
2	13	Quit Claim Deed	Kivalina IRA Council	56	861	9/14/2000
3	13	Trustee Deed	City of Kivalina	34	613-614	10/19/1988
4	14	Trustee Deed	City of Kivalina	34	615-616	10/19/1988
5	14	Trustee Deed	NANA Regional Housing Authority	23	460	5/24/1982
6	14	Trustee Deed	City of Kivalina	34	617-618	10/19/1988

POA-2023-00230
NANA Construction Office Building
Chukchi Sea
Lat. 67.72698, Long. -164.54009

Warranty: The information is current as of September 2023. No other previous information facility records.

This map is based on photography acquired on June 12, 2013, at a nominal scale of 1 in = 800 ft. Quantum Spatial prepared the orthophoto and topographic mapping. The topographic contours were prepared at two (2) foot intervals with index contours every ten (10) feet.

HORIZONTAL AND VERTICAL CONTROL: The horizontal and vertical control station for this digital map and orthophoto was an NGS OPUS solution for a 2011 Kivalina Airport Monument. The horizontal datum NAD 1983 coordinates for this monument are North 67° 43' 46.66187" and West 164° 32' 44.50836". The Geoid 12 elevation for this monument is 16.05 ft.

This map projection is based upon NAD 83, ASP Zone 8 as expressed in US Survey Feet.

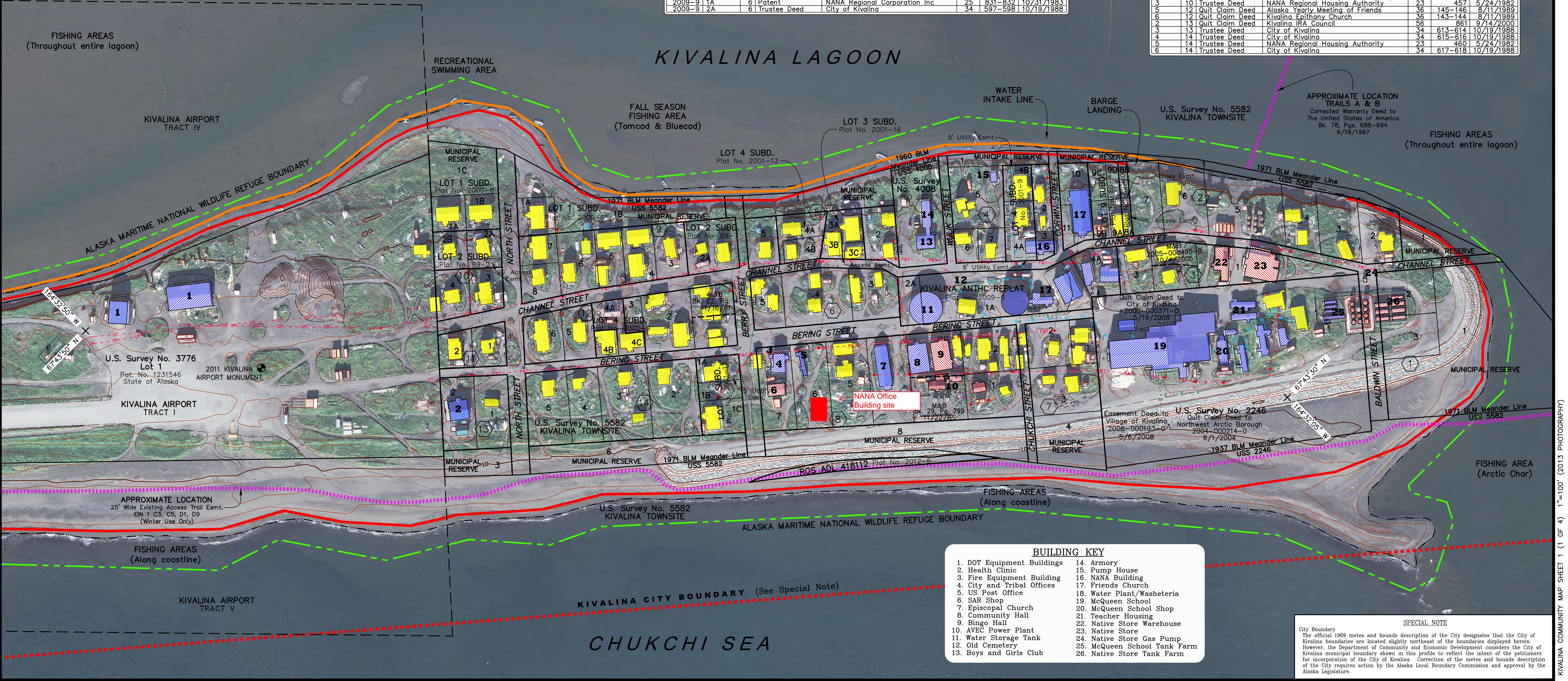

BUILDING KEY	
1. DOT Equipment Buildings	14. Armory
2. Health Clinic	15. Pump House
3. Fire Equipment Building	16. NANA Building
4. City and Tribal Offices	17. Friends Church
5. US Post Office	18. Water Plant/Washeteria
6. SAR Shop	19. McQueen School
7. Episcopal Church	20. McQueen School Shop
8. Community Hall	21. Teacher Housing
9. Bingo Hall	22. Native Store Warehouse
10. AVEC Power Plant	23. Native Store
11. Water Storage Tank	24. Native Store Gas Pump
12. Old Cemetery	25. McQueen School Tank Farm
13. Boys and Girls Club	26. Native Store Tank Farm

SPECIAL NOTE

City Boundary
The official 1969 metes and bounds description of the City designates that the City of Kivalina boundaries are located slightly northeast of the boundaries displayed herein. However, the Department of Commerce and Economic Development considers the City of Kivalina municipal boundary shown in this profile to reflect the intent of the petitioners for incorporation of the City of Kivalina. Correction of the metes and bounds description of the City requires action by the Alaska Local Boundary Commission and approval by the Alaska Legislature.