

THIS PROJECT IS LOCATED WITHIN THE HARRISON BAY (A-1) QUADRANGLE

ConocoPhillips
Alaska, Inc.

AREA: _____ MODULE: XXXX UNIT: _____
DS2S DEVELOPMENT PROJECT
PROPOSED GRAVEL ROAD & PAD
VICINITY MAP

CADD FILE NO. LK6219d27	02/11/15	DRAWING NO. NSK 6.219-d27	PART: 1 OF 3	REV: 0
----------------------------	----------	------------------------------	-----------------	-----------

THIS PROJECT IS LOCATED WITHIN THE HARRISON BAY (A-1) QUADRANGLE



PROJECT CENTROID
 NAD83 GEOGRAPHIC:
 70° 13' 56.6" N
 150° 11' 41.9" W
 ASP NAD83 - ZONE 4
 N: 5,934,439
 E: 1,616,263

PROPOSED GRAVEL ROAD AND PAD
 IMPACT AREA:
 31,363 S.F. / 0.72 ACRES
 VOLUME:
 4,500 CU.YD.

NOTE:
 1. QUANTITIES ARE BASED ON APPROXIMATELY 5' OF FILL WITH 2:1 SIDE SLOPES.

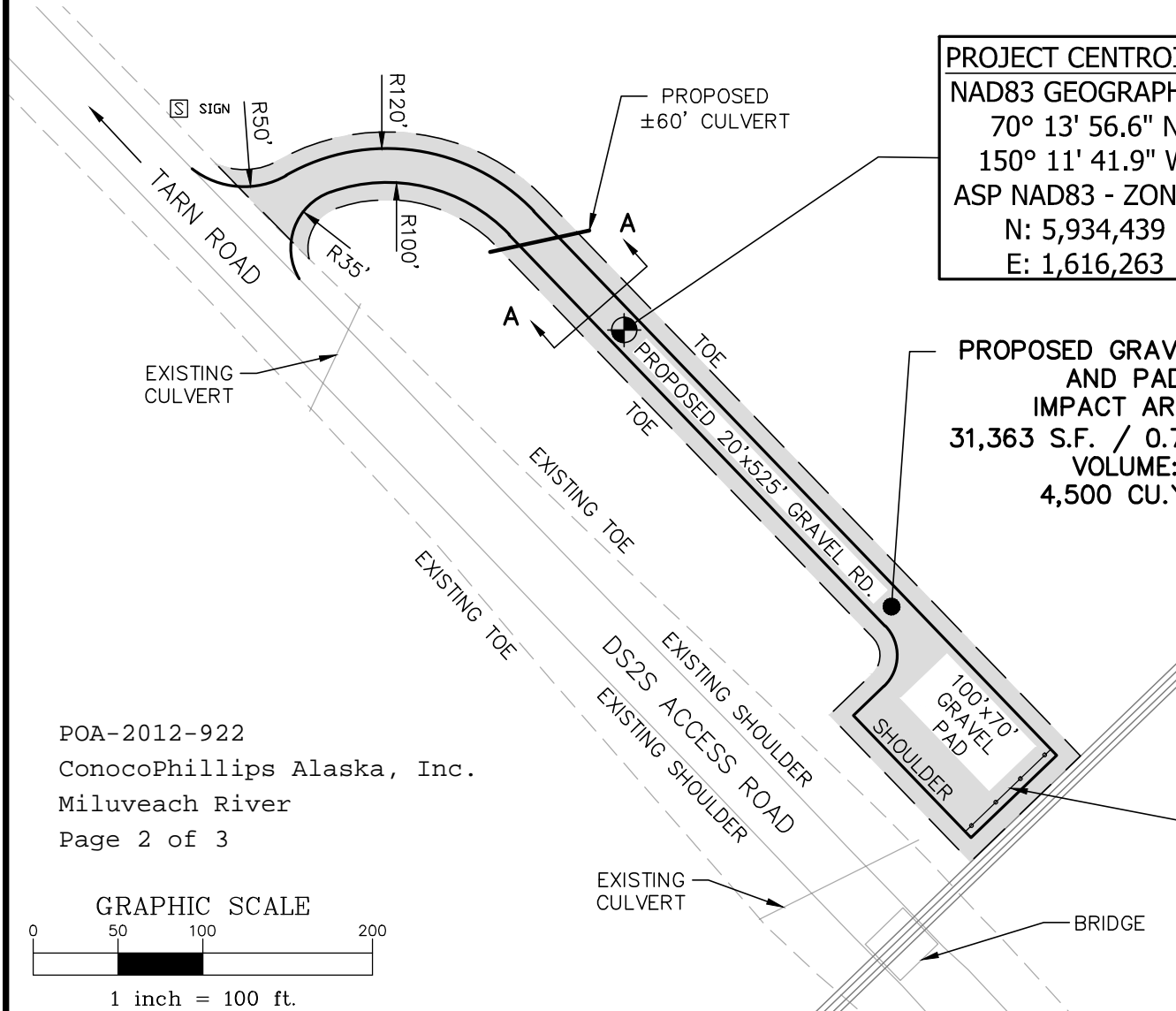

POA-2012-922
 ConocoPhillips Alaska, Inc.
 Miluveach River
 Page 2 of 3

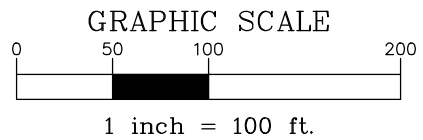

PROPOSED GUARDRAIL
 (5' FROM SHOULDER
 AT 20' SPACING)



FORM: AsizeL-3L-Title

				ConocoPhillips Alaska, Inc.		AREA:	MODULE: XXXX	UNIT:
				APPROVAL: -		DS2S DEVELOPMENT PROJECT PROPOSED GRAVEL ROAD AND PAD PERMIT EXHIBIT		
				DATE: 02/11/15 LK6219D27				
				DRAWING NO. NSK 6.219 - d27		PART:	2 of 3	REV:
REV. NO.	CUST APP	DATE	REVISIONS	BY	CHK	JOB ENGR	PROJ ENGR	0

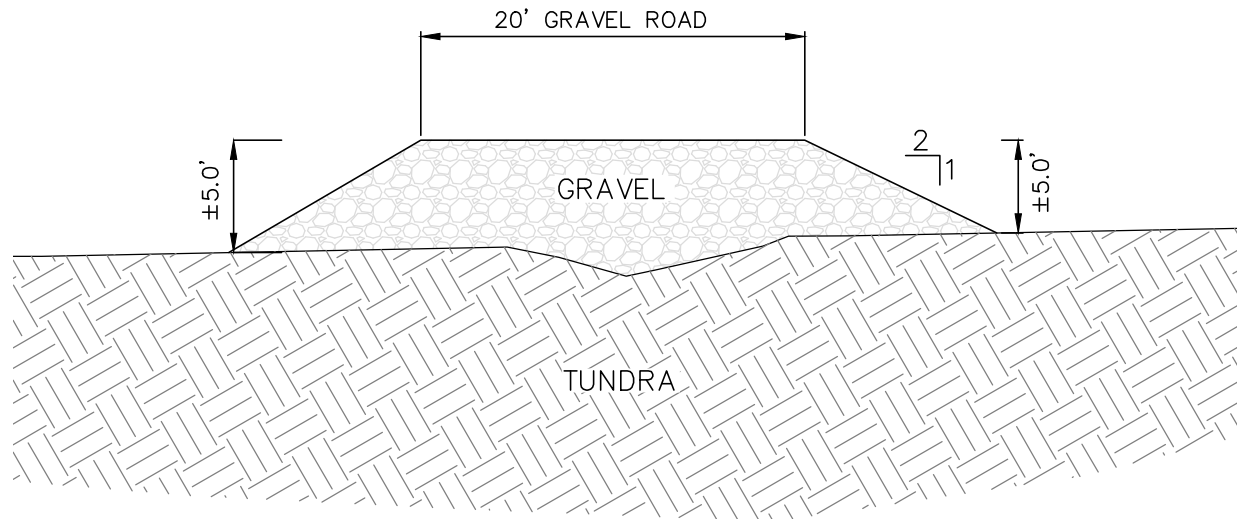

POA-2012-922

ConocoPhillips Alaska, Inc.

Miluveach River

Page 3 of 3

DETAIL "A"

SCALE: 1" = 10'.



FORM: AsizeL-3L-Title

				ConocoPhillips Alaska, Inc.				AREA:	MODULE: XXXX	UNIT:
				APPROVAL: -				DS2S DEVELOPMENT PROJECT PROPOSED GRAVEL ROAD AND PAD CROSS SECTION		
				DATE: 02/11/15 LK6219D27						
				DRAWING NO. NSK 6.219 - d27				PART:	3 of 3	REV:
REV. NO.	CUST APP	DATE	REVISIONS	BY	CHK	JOB ENGR	PROJ ENGR			