

This map is based on U.S.G.S quad Beechey Point (B-4) and on the Unit Operator's Facility Maps.



PROJECT LOCATION:

MILNE POINT UNIT - J PAD
 NAD83
 LAT. = 70° 27' 03.654" / DD 70.451015
 LONG. = -149° 34' 40.553" / DD -149.577931

 ALASKA STATE PLANE ZONE 4, NAD83
 X = 1,692,145.07 FEET
 Y = 6,014,599.20 FEET

 SEC. 28 T13N, R10E UMIAT M.
 ADL # 025906

DATUM: MEAN SEA LEVEL

PURPOSE: GRAVEL EXPANSION

ADJACENT PROPERTY OWNER:
 STATE OF ALASKA

POA-2013-399		
BP EXPLORATION (ALASKA) INC.		
MILNE POINT UNIT J PAD GRAVEL FOR RIG ACCESS VICINITY MAP		
DATE: May 2013	SCALE: 1" = 1 Mile	FIGURE: 1

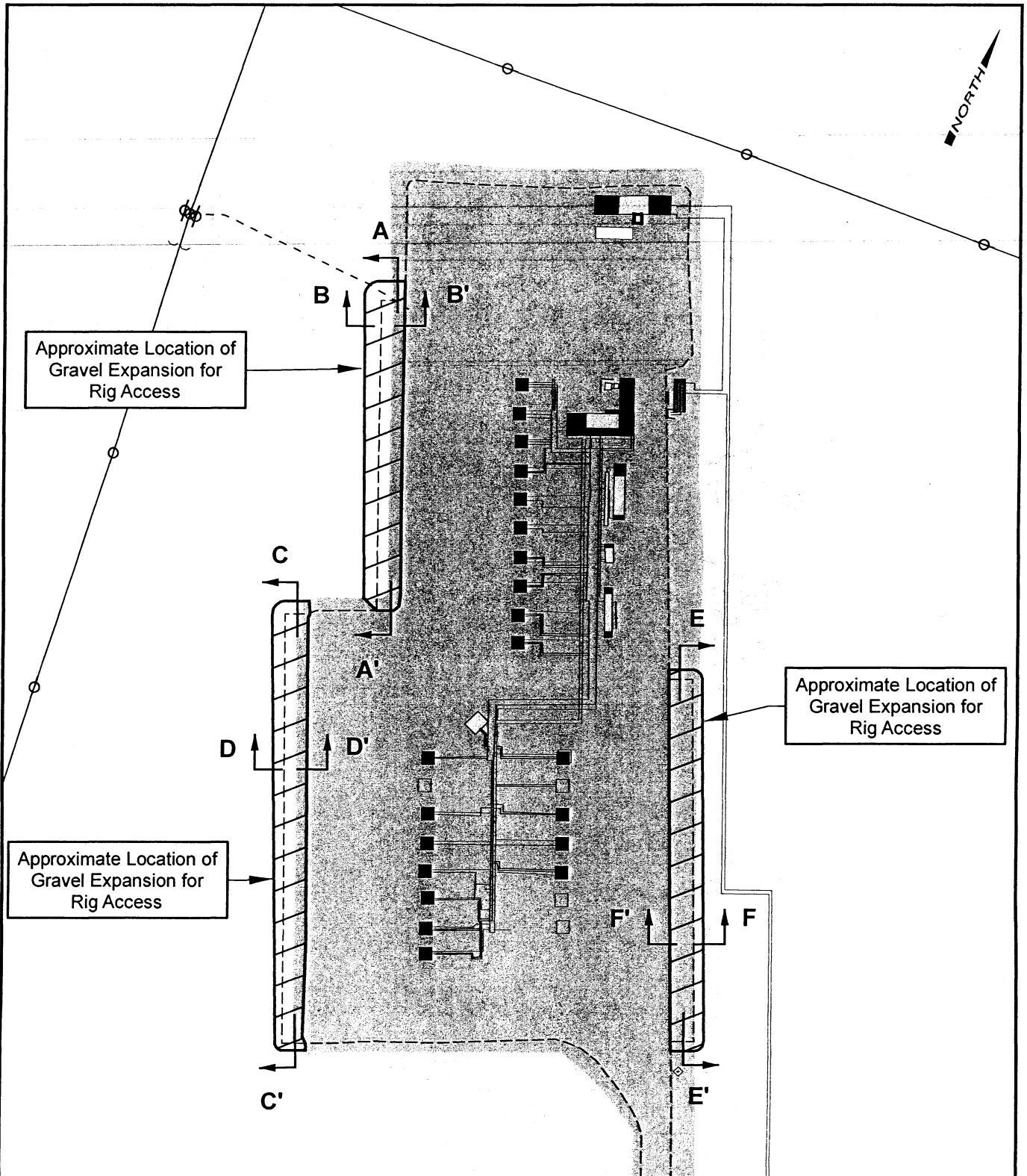

Northwest Impacted Tundra	0.30 ACRES
Northwest Gravel Expansion Volume	4,500 CY
Southwest Impacted Tundra	0.30 ACRES
Southwest Gravel Expansion Volume	2,500 CY
East Impacted Tundra	0.30 ACRES
East Gravel Expansion Volume	2,500 CY
Total Impacted Tundra	0.90 ACRES
Total Gravel Expansion Volume	9,500 CY

Calculations are Approximate. Volume includes +20% for Settling.
Project Surveyed by Bell and Assoc. in April 2013.

POA-2013-399		
BP EXPLORATION (ALASKA) INC.		
MILNE POINT UNIT		
J PAD		
GRAVEL FOR RIG ACCESS		
LOCATION MAP		
DATE: June 2013	SCALE: 1" = 150'	FIGURE: 2

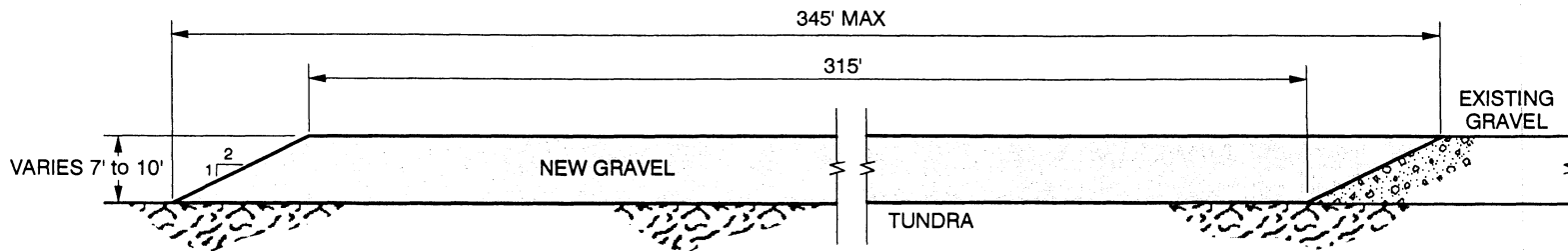

GRAVEL EXPANSION A-A'

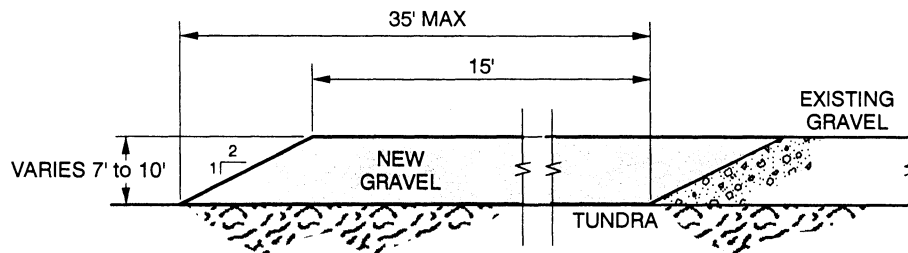

GRAVEL EXPANSION B-B'

POA-2013-399		
BP EXPLORATION (ALASKA) INC.		
MILNE POINT UNIT J PAD GRAVEL FOR RIG ACCESS CROSS SECTIONS		
DATE: June 2013	SCALE: 1" = 20'	FIGURE: 3

ALL DIMENSIONS ARE APPROXIMATE

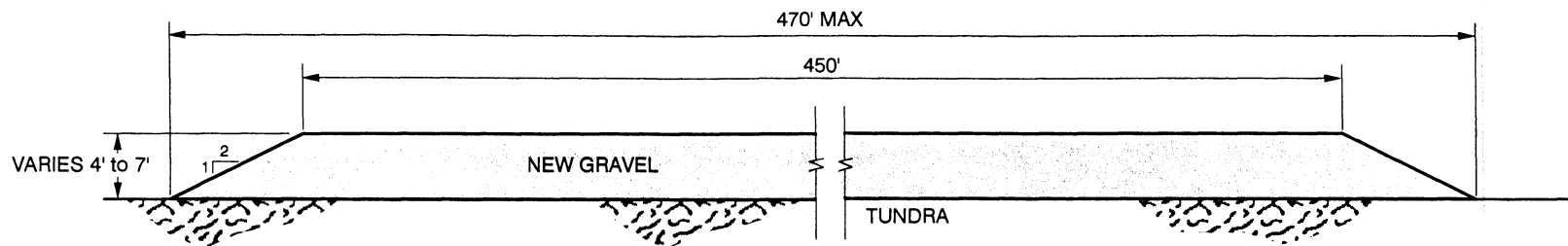

GRAVEL EXPANSION C-C'

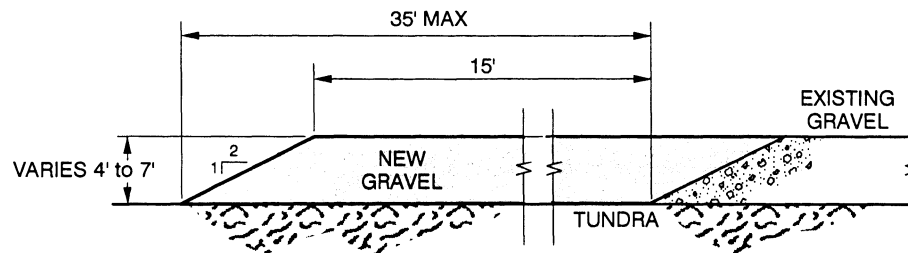

GRAVEL EXPANSION D-D'

<i>POA-2013-399</i>		
BP EXPLORATION (ALASKA) INC.		
MILNE POINT UNIT J PAD GRAVEL FOR RIG ACCESS CROSS SECTIONS		
DATE: May 2013	SCALE: 1" = 15'	FIGURE: 4

ALL DIMENSIONS ARE APPROXIMATE

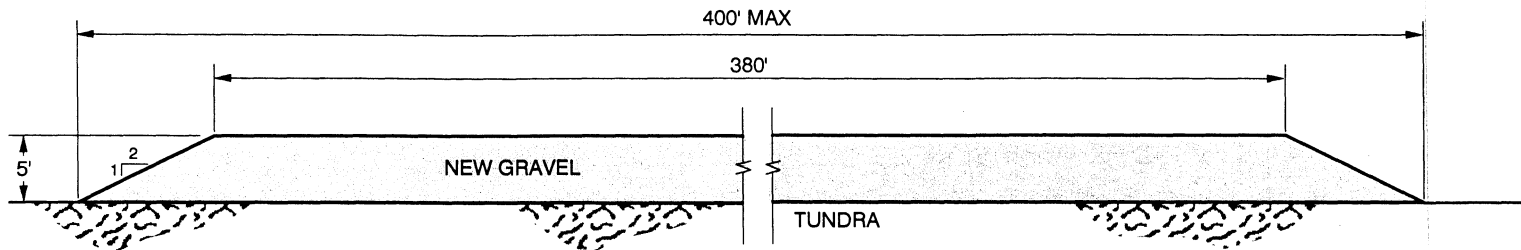

GRAVEL EXPANSION E-E'

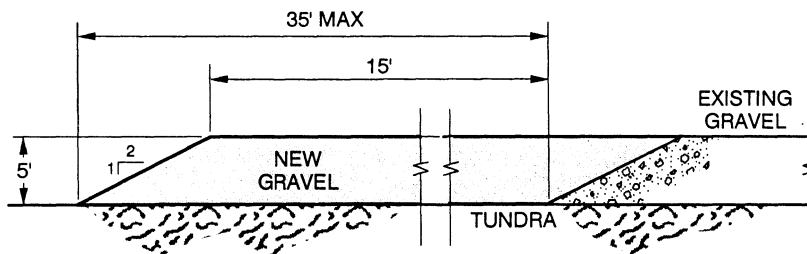

GRAVEL EXPANSION F-F'

POA-2013-399		
BP EXPLORATION (ALASKA) INC.		
MILNE POINT UNIT J PAD GRAVEL FOR RIG ACCESS CROSS SECTIONS		
DATE: May 2013	SCALE: 1" = 14'	FIGURE: 5

ALL DIMENSIONS ARE APPROXIMATE