

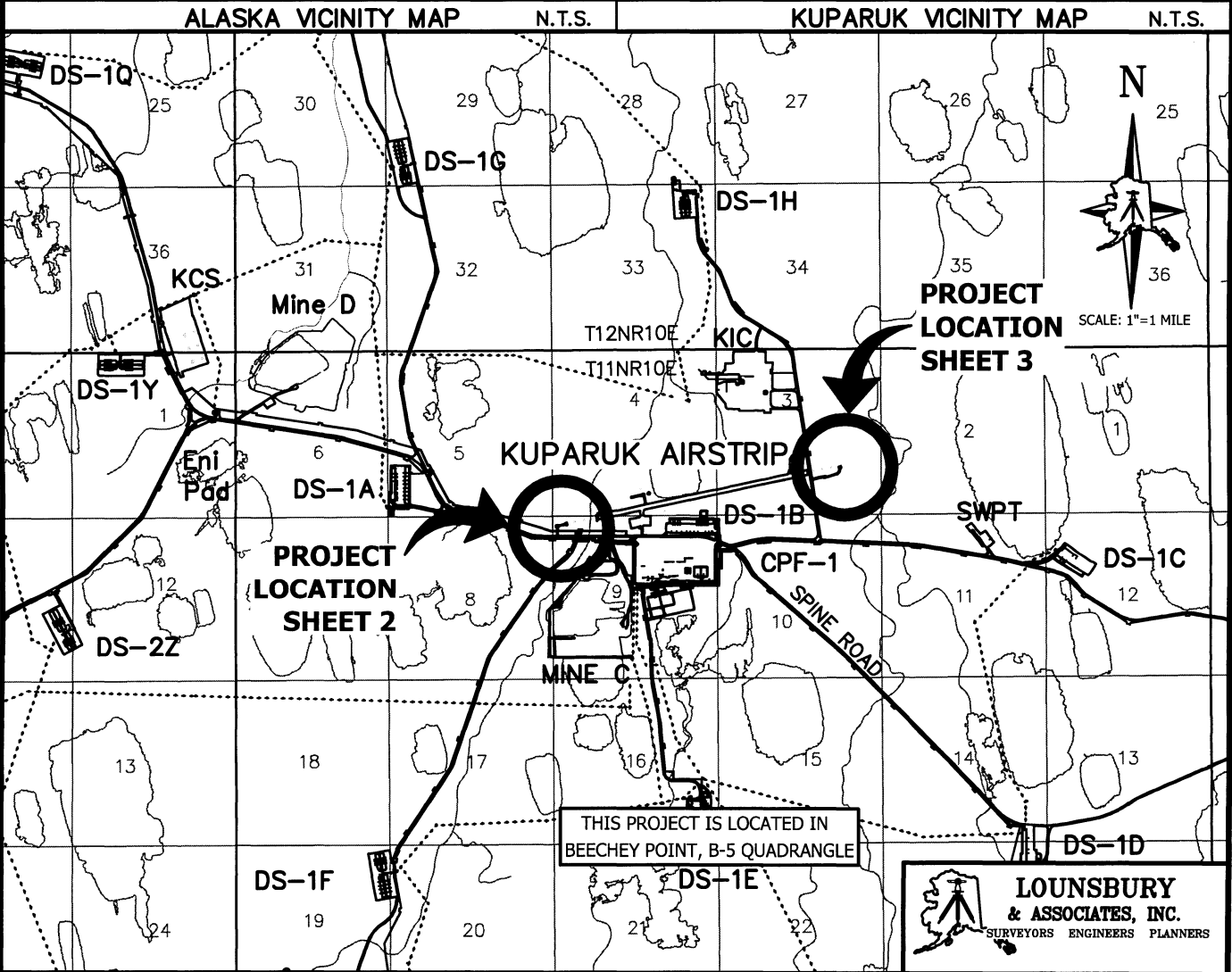

REV	DATE	BY	CK	APP	DESCRIPTION	REV	DATE	BY	CK	APP	DESCRIPTION
4	3/06/15	NRB	SZ		Added Alaska Vicinity Map	3	10/24/14	JFC	MEH		Add Proposed Culverts

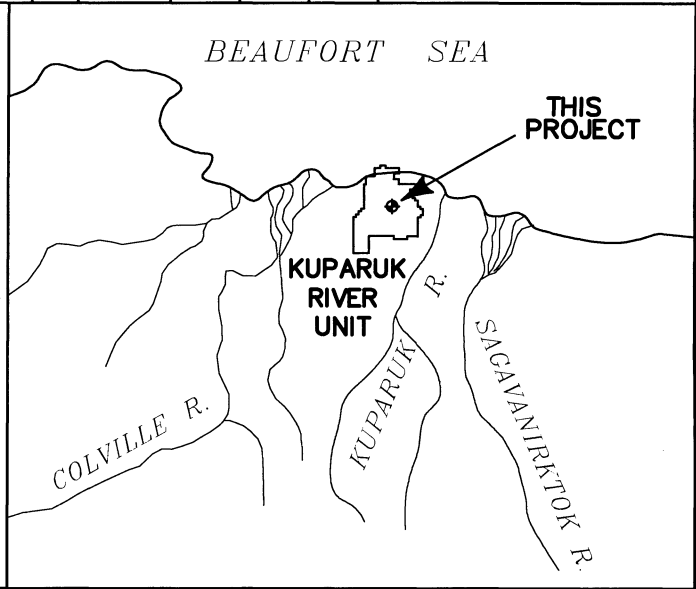

 <b>ConocoPhillips</b> Alaska, Inc.	AREA:	MODULE: XXXX	UNIT:
	KUPARUK LANDING AIRSTRIP PROPOSED MALSR POA-2015-159, Ugnuravik River ConocoPhillips Alaska, Inc.		
CADD FILE NO. LK604D60	8/31/13	DRAWING NO. NSK 6.04-d60	Drawings dated August 31, 2013 Sheet 1 of 7

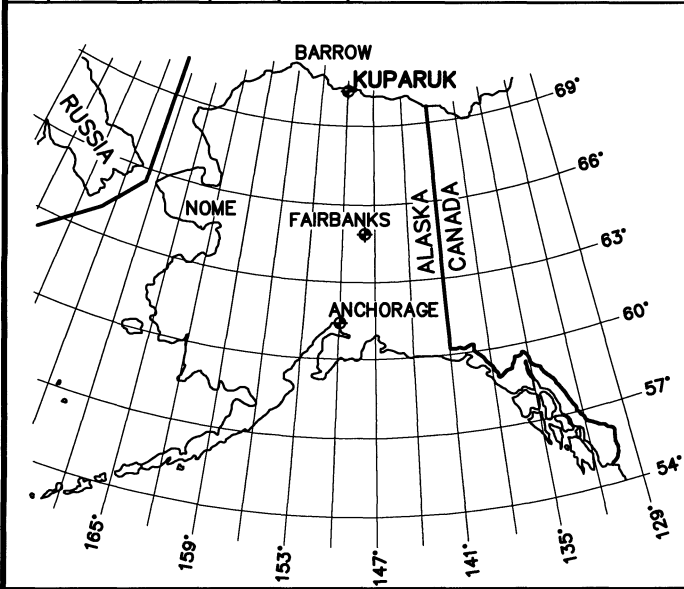



 = PROJECT CENTROID  
 N 5,971,682 ASP NAD27, ZONE 4  
 E 554,388  
 LAT. 70 19' 58.9"  
 LONG. 149 33' 42.9" ASP NAD83, GEOGRAPHIC



 PROPOSED 20' WIDE GRAVEL ACCESS RD. FOR MALSRS LIGHTS. (TYP.)

PROPOSED GRAVEL:  
 IMPACTED AREA = 0.80 ACRES  
 VOLUME = 4935 CU. YDS.

PROPOSED GRAVEL:  
 IMPACTED AREA = 1.11 ACRES  
 VOLUME = 6850 CU. YDS.

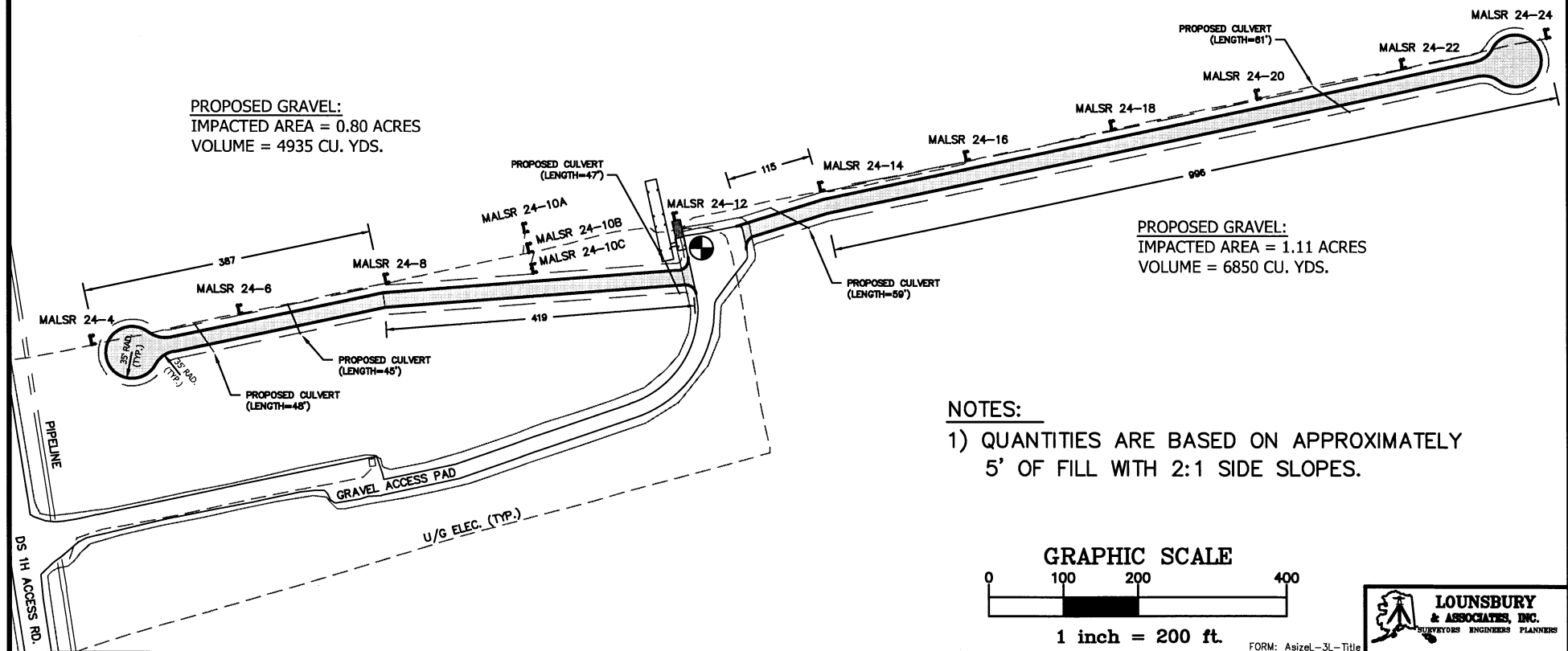

**NOTES:**

- 1) QUANTITIES ARE BASED ON APPROXIMATELY 5' OF FILL WITH 2:1 SIDE SLOPES.

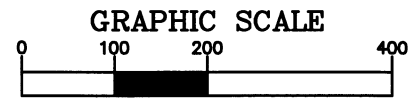

REV. NO.	CUST APP	DATE	REVISIONS	BY	CHK	JOB ENGR	PROJ ENGR
4		3/6/15	Change Diminsions to Toe	NRB	SZ		
3		10/24/14	Add Proposed Culverts	JFC	MEH		
2		3/22/14	Changned Impacted area to Acres	MEH	JAH		
1		10/18/13	Changned Rd. Width to 20'	JFC	MBS		

**ConocoPhillips**  
 Alaska, Inc.

APPROVAL: \_\_\_\_\_  
 DATE: 8/31/13  
 DRAWING NO. **NSK 6.04-d60**

**KUPARUK LANDING AIRSTRIP**  
**PROPOSED MALSRS LT. ACCESS RDS. & CULVERTS**  
**PERMIT DRAWING**  
 POA-2015-159, Ugnuravik River  
 ConocoPhillips Alaska, Inc.  
 Drawings dated August 31, 2013  
 Sheet 3 of 7

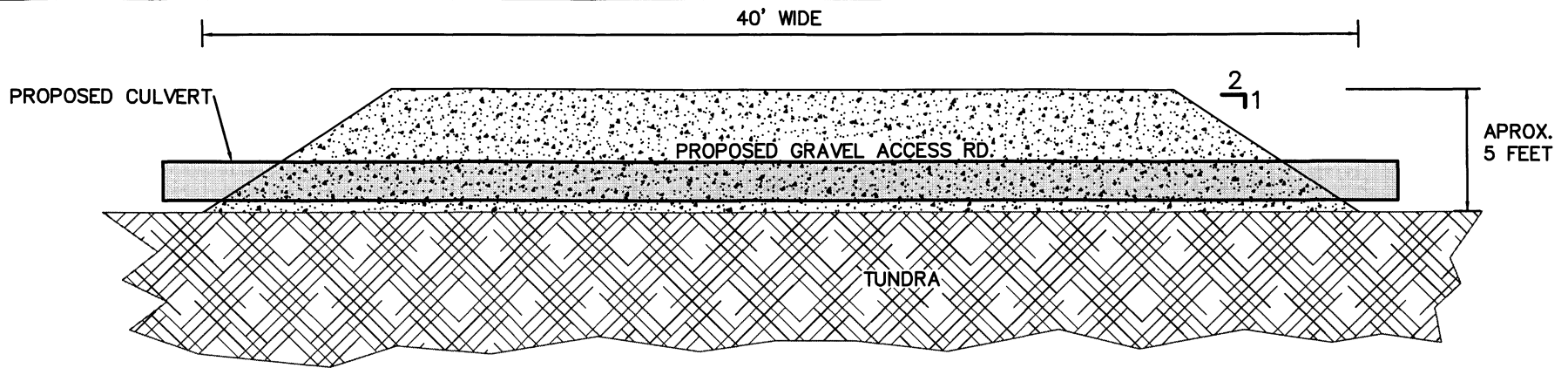

( TYPICAL GRAVEL ACCESS RD. CROSS-SECTION DETAIL )

NTS

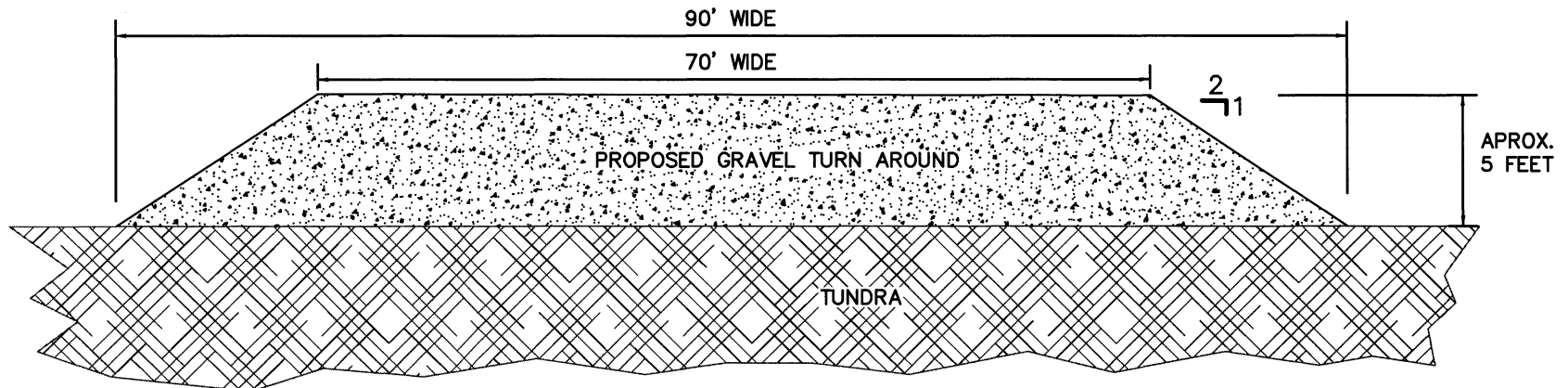

( TYPICAL TURN AROUND CROSS-SECTION DETAIL )

NTS



FORM: AsizeL-3L-Title

REV. NO.	CUST APP	DATE	REVISIONS	BY	CHK	JOB ENGR	PROJ ENGR
5		03/24/15	ADD TURN AROUND DETAIL	JAH	MBS		
4		3/6/15	Change Diminions to Toe	NRB	SZ		
3		10/24/14	Add Proposed Culverts	JFC	MEH		
2		3/22/14	Changed Impacted area to Acres	MEH	JAH		
1		10/18/13	Changed Rd. Width to 20'	JFC	MBS		

**ConocoPhillips**  
Alaska, Inc.

APPROVAL:

DATE: 8/31/13

DRAWING NO.

NSK 6.04-d60

KUPARUK LANDING AIRSTRIP  
PROPOSED MALSR LT. ACCESS RDS. & CULVERTS  
PERMIT DRAWING

POA-2015-159, Ugnuravik River  
ConocoPhillips Alaska, Inc.  
Drawings dated August 31, 2013  
Sheet 4 of 7



## KLA Lighting Access Roads Kuparuk River Unit

### Project Description

ConocoPhillips Alaska, Inc. (CPAI) requests authorization to construct five gravel roads at the Kuparuk Landing Area (KLA) to provide maintenance access to the landing approach lights at each end of the airstrip.

Each road will be approximately 40 feet wide (including the shoulder and toe) by 5 feet deep and will terminate at a turnaround with a diameter of approximately 70 feet. Each road will meet the elevation of the existing pads and roads. The gravel expansion will include approximately 21,365 cubic yards of gravel fill, impacting 3.44 acres of surface area. Please see the attached drawings which depict the five gravel roads as Road A, B, C, D, and E.

Road A will connect to the Spine Road approximately 1,900 feet west of the western edge of KLA. Road A will be approximately 431 feet long and approximately 40 feet wide. Three culverts will be installed with the road. Two of the culverts will be installed near the western end of the road near the terminus and will be approximately 51 feet long. The third culvert will be installed at the eastern end of the road near the turnaround and will be approximately 54 feet long. The proposed gravel fill for Road A is 2,800 cubic yards, impacting 0.44 acres of surface area.

Road B will connect to the NDB Access Road approximately 1,300 feet west of the western edge of KLA. Road B will be approximately 286 feet long and approximately 40 feet wide. Two culverts will be installed with the road. One culvert will be installed near the turnaround at the eastern end of the road and will be approximately 45 feet long. One culvert will be installed near the NDB

Access Road and will be approximately 49 feet long. The proposed gravel fill for Road B is approximately 2,030 cubic yards, impacting 0.32 acres of surface area.

Road C will connect to the north-eastern terminus of the NDB Access Road approximately 1,000 feet west of the eastern edge of KLA. Road C will be approximately 771 feet long and approximately 40 feet wide. Four culverts will be installed along the length of the road. One culvert will be installed near the turnaround at the eastern end of the road and will be approximately 45 feet long. Three culverts will be installed along the remaining length of the road and will be various lengths, between approximately 45 and 67 feet long each. The proposed gravel fill for Road C is approximately 4,750 cubic yards, impacting 0.77 acres of surface area.

Road D will connect to the Gravel Access Pad approximately 1,100 feet east of the eastern edge of KLA. Road D will be approximately 806 feet long and approximately 40 feet wide. Three culverts will be installed along the length of the road. One culvert will be installed near the turnaround at the western end of the road and will be approximately 48 feet long. Two culverts will be installed along the remaining length of the road. One will be approximately 45 feet long and one will be approximately 47 feet long. The proposed gravel fill for Lighting Access Road D is approximately 4,935 cubic yards, impacting 0.80 acres of surface area.

Road E will connect to the Gravel Access Pad approximately 1,050 feet east of the eastern edge of KLA. Road E will be approximately 1,111 feet long and approximately 40 feet wide. Two culverts will be installed with the road. One culvert will be installed near the Gravel Pad Access Road and will be approximately 59 feet long. One culvert will be installed near the turnaround at the eastern end of the road and will be approximately 61 feet long. The proposed gravel fill for Lighting Access Road D is approximately 6850 cubic yards, impacting 1.11 acres of surface area.

Project work is expected to begin August 15, 2015 and be completed by May 31, 2016. Please see the attached figures for additional details.