

TIDAL INFORMATION

WATER LEVEL	ELEVATION
EST. MAX HIGH WATER	17.05
MHHW	12.14
MHW	11.21
MLW	1.51
MLLW	0.00
EST. MAX LOW WATER	-5.45

ABOVE INFO PROVIDED BY NOAA TIDAL DATUM 9/30/2011

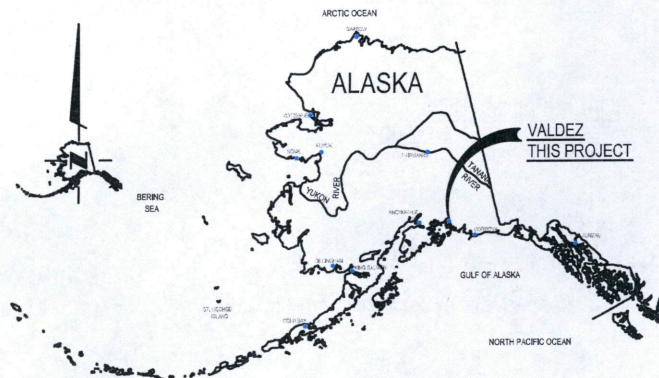

LOCATION MAP

NOT TO SCALE



U.S.G.S LOCATION MAP

1" = 1 MILE

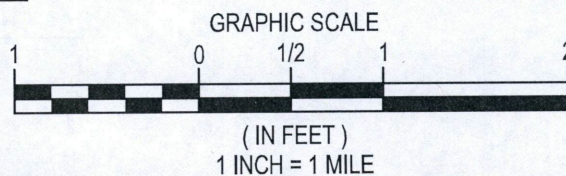

CITY: VALDEZ BOROUGH: N/A STATE: ALASKA
 DIRECTIONS: FROM INTERSECTION OF AIRPORT ROAD
 AND RICHARDSON HIGHWAY APPROXIMATELY 3.7
 MILES FROM VALDEZ POST OFFICE. GO SOUTHWEST
 ON MINERAL CREEK LOOP ROAD 0.4 MILES ACCESS IS
 VIA OLD DOCK ACROSS FROM VFDA OR OLD VALDEZ
 DOCK AREA.

APPLICANT: VALDEZ FISHERIES DEVELOPMENT ASSOC
 FILE NO.: POA-2016-537
 WATERWAY: PORT VALDEZ
 PROPOSED ACTIVITY: NEW NET PEN STORAGE
 SEC. 3, T. 9 S., R. 6 W., COPPER RIVER MERIDIAN
 LAT.: N 61°07'13" LONG.: W 146°16'47" NAD 83
 SHEET 1 OF 7 DATE: 1/5/17

TIDAL INFORMATION

WATER LEVEL	ELEVATION
EST. MAX HIGH WATER	17.05
MHHW	12.14
MHW	11.21
MLW	1.51
MLLW	0.00
EST. MAX LOW WATER	-5.45

ABOVE INFO PROVIDED BY NOAA TIDAL DATUM 9/30/2011



INTERSECTION AIRPORT RD
AND RICHARDSON HWY

THIS PROJECT

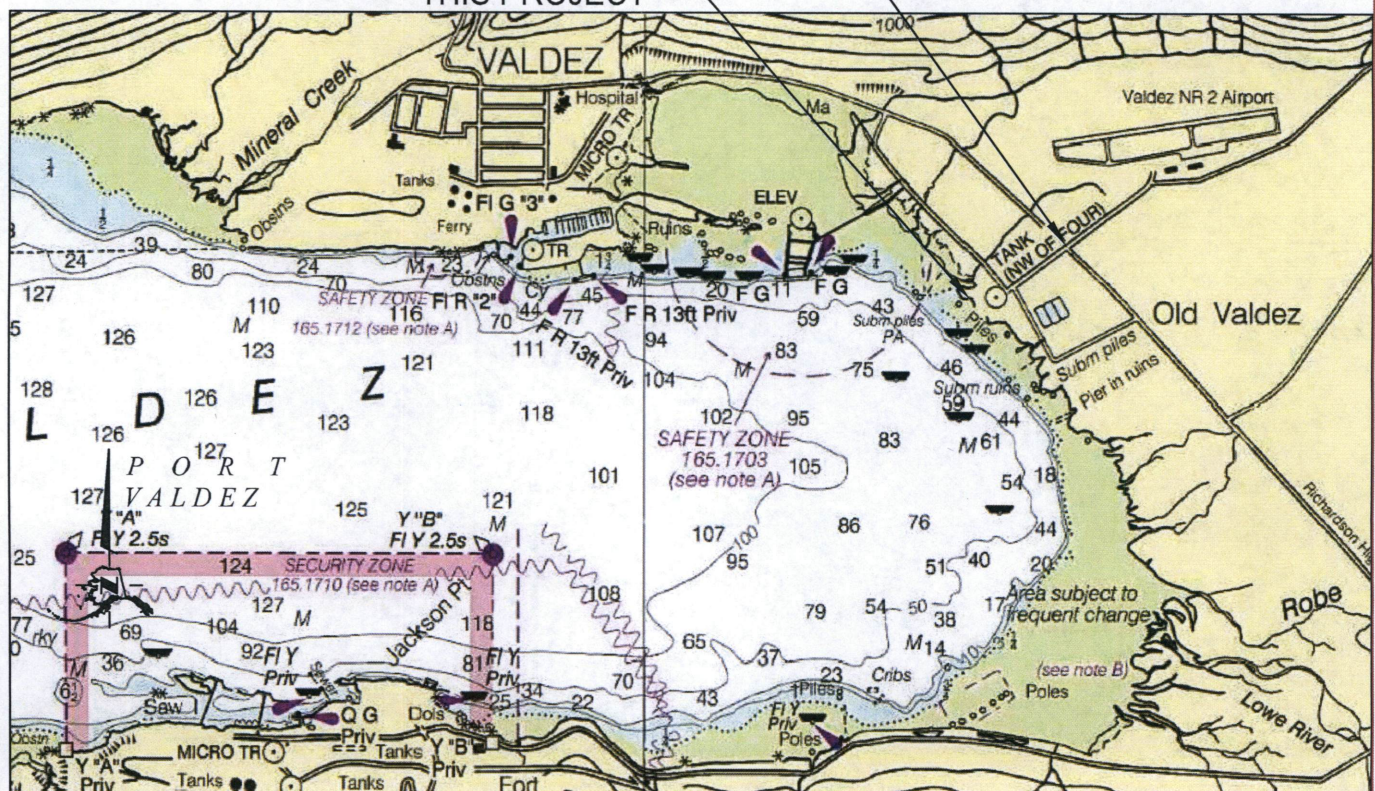

NOAA CHART LOCATION MAP

1" = 1 MILE

GRAPHIC SCALE

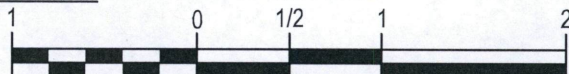

(IN FEET)

1 INCH = 1 MILE

CITY: VALDEZ BOROUGH: N/A STATE: ALASKA
DIRECTIONS: FROM INTERSECTION OF AIRPORT ROAD
AND RICHARDSON HIGHWAY APPROXIMATELY 3.7
MILES FROM VALDEZ POST OFFICE. GO SOUTHWEST
ON MINERAL CREEK LOOP ROAD 0.4 MILES ACCESS IS
VIA OLD DOCK ACROSS FROM VFDA OR OLD VALDEZ
DOCK AREA.

APPLICANT: VALDEZ FISHERIES DEVELOPMENT ASSOC
FILE NO.: POA-2016-537
WATERWAY: PORT VALDEZ
PROPOSED ACTIVITY: NEW NET PEN STORAGE
SEC. 3, T. 9 S., R. 6 W., COPPER RIVER MERIDIAN
LAT.: N 61°07'13" LONG.: W 146°16'47" NAD 83
SHEET 2 OF 7 DATE: 1/5/17

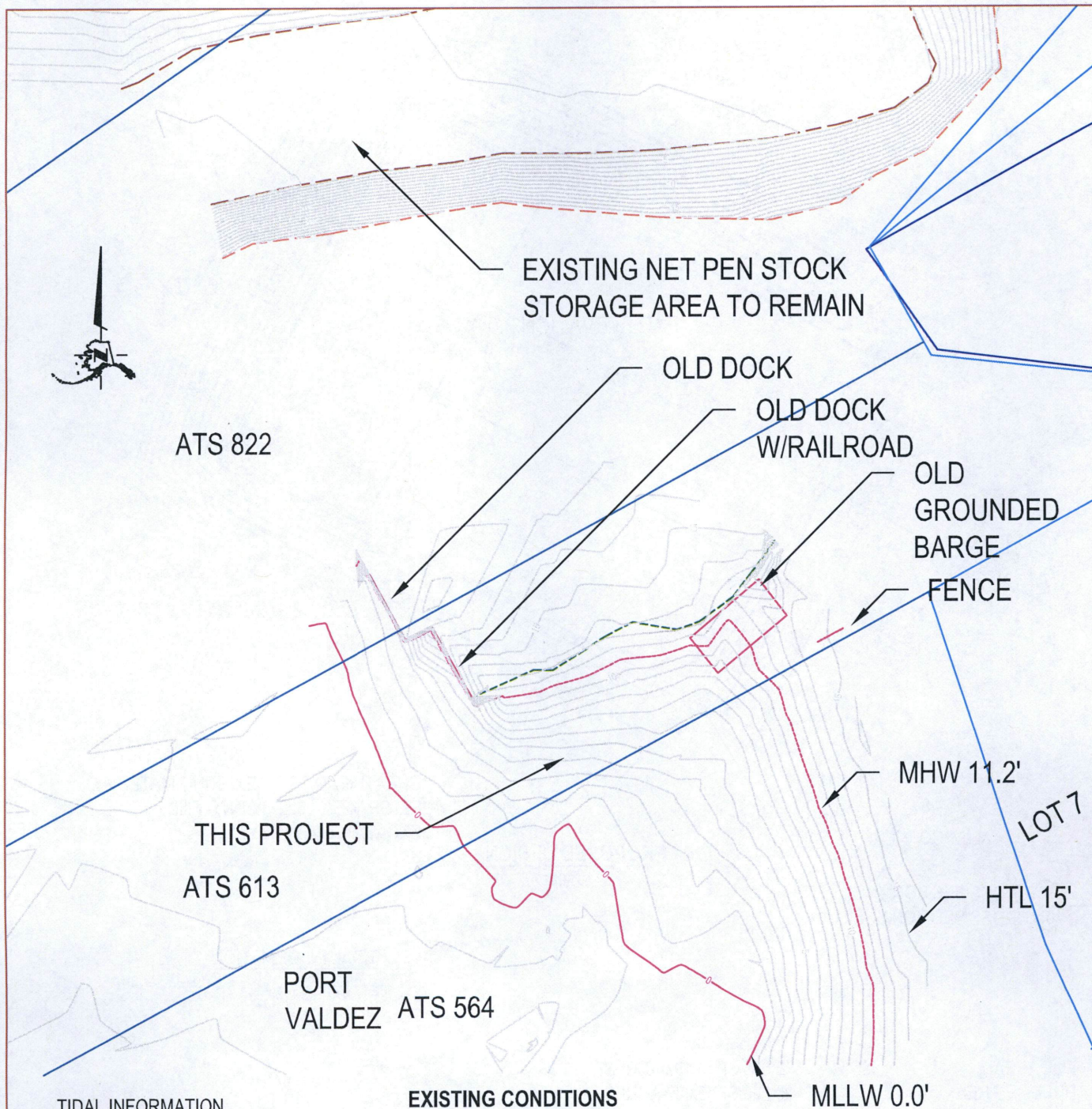

TIDAL INFORMATION

WATER LEVEL	ELEVATION
EST. MAX HIGH WATER	17.05
MHHW	12.14
MHW	11.21
MLW	1.51
MLLW	0.00
EST. MAX LOW WATER	-5.45

EXISTING CONDITIONS

1" = 100 FEET

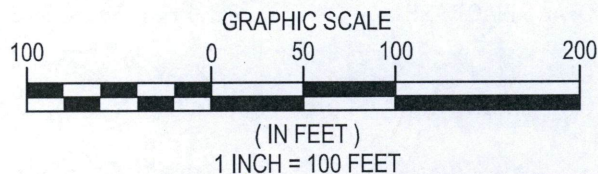

ABOVE INFO PROVIDED BY NOAA TIDAL DATUM 9/30/2011

CITY: VALDEZ BOROUGH: N/A STATE: ALASKA
 DIRECTIONS: FROM INTERSECTION OF AIRPORT ROAD
 AND RICHARDSON HIGHWAY APPROXIMATELY 3.7
 MILES FROM VALDEZ POST OFFICE. GO SOUTHWEST
 ON MINERAL CREEK LOOP ROAD 0.4 MILES ACCESS IS
 VIA OLD DOCK ACROSS FROM VFDA OR OLD VALDEZ
 DOCK AREA.

APPLICANT: VALDEZ FISHERIES DEVELOPMENT ASSOC
 FILE NO.: POA-2016-537
 WATERWAY: PORT VALDEZ
 PROPOSED ACTIVITY: NEW NET PEN STORAGE
 SEC. 3, T. 9 S., R. 6 W., COPPER RIVER MERIDIAN
 LAT.: N 61°07'13" LONG.: W 146°16'47" NAD 83
 SHEET 3 OF 7 DATE: 1/5/17

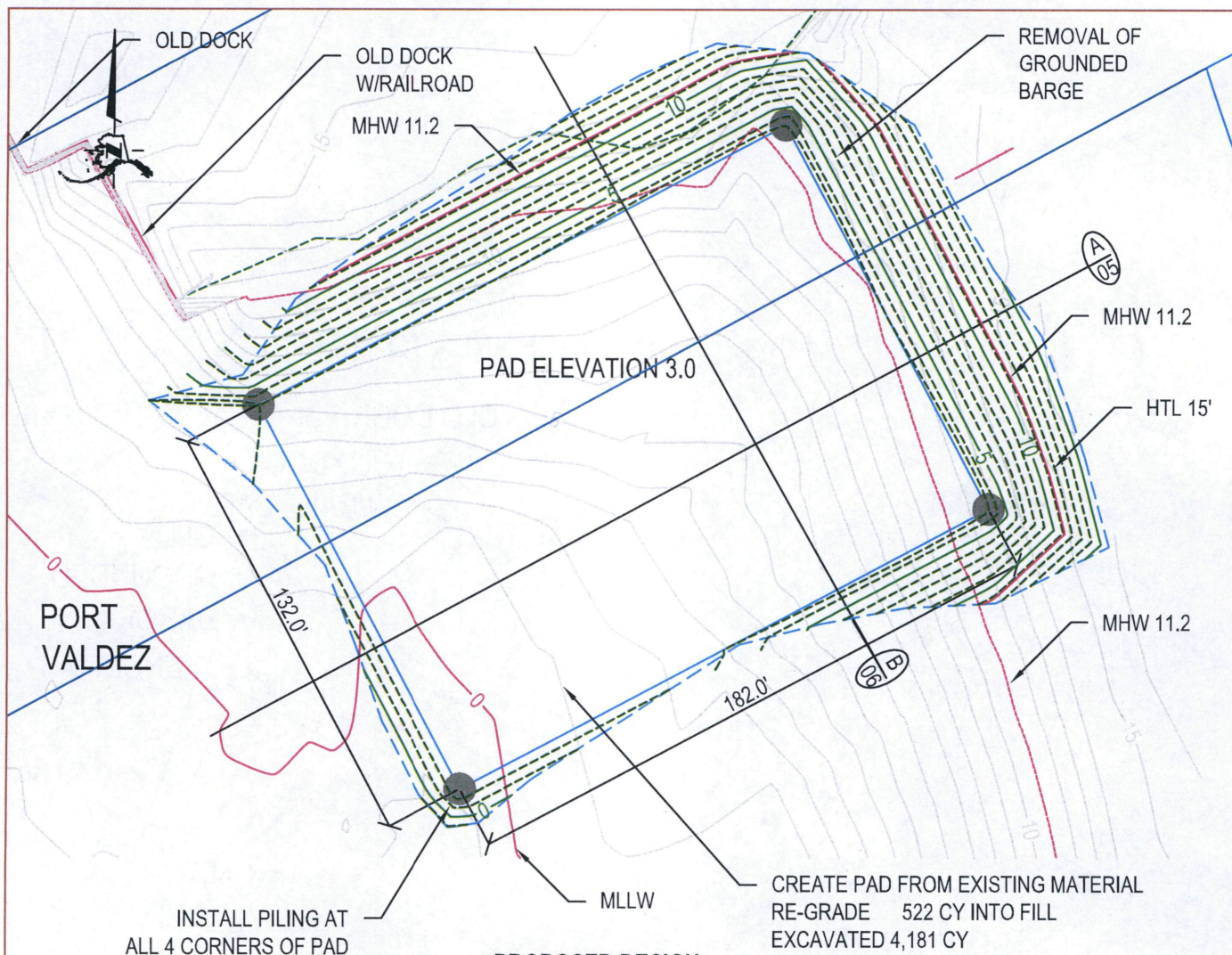

PROPOSED DESIGN

1" = 50 FEET

(A) CROSS SECTION #
05 CROSS SECTION SHEET #

FILL AREA: 8,585 SF (0.197 ACRES)
DREDGE AREA: 29,926 SF (0.687 ACRES)
AREA IMPACTED BELOW MHW: 35,686 SF (0.819 ACRES)
TOTAL IMPACT AREA: 38,511 SF (0.884 ACRES)

TOTAL FILL: 522 CY
TOTAL EXCAVATION: 4,181 CY

TIDAL INFORMATION

WATER LEVEL	ELEVATION
EST. MAX HIGH WATER	17.05
MHHW	12.14
MHW	11.21
MLW	1.51
MLLW	0.00
EST. MAX LOW WATER	-5.45

ABOVE INFO PROVIDED BY NOAA
TIDAL DATUM 9/30/2011

GRAPHIC SCALE

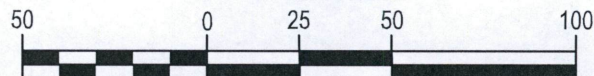

(IN FEET)
1 INCH = 50 FEET

CITY: VALDEZ BOROUGH: N/A STATE: ALASKA
DIRECTIONS: FROM INTERSECTION OF AIRPORT ROAD AND RICHARDSON HIGHWAY APPROXIMATELY 3.7 MILES FROM VALDEZ POST OFFICE. GO SOUTHWEST ON MINERAL CREEK LOOP ROAD 0.4 MILES ACCESS IS VIA OLD DOCK ACROSS FROM VFDA OR OLD VALDEZ DOCK AREA.

APPLICANT: VALDEZ FISHERIES DEVELOPMENT ASSOC
FILE NO.: POA-2016-537
WATERWAY: PORT VALDEZ
PROPOSED ACTIVITY: NEW NET PEN STORAGE
SEC. 3, T. 9 S., R. 6 W., COPPER RIVER MERIDIAN
LAT.: N 61°07'13" LONG.: W 146°16'47" NAD 83
SHEET 4 OF 7 DATE: 1/5/17

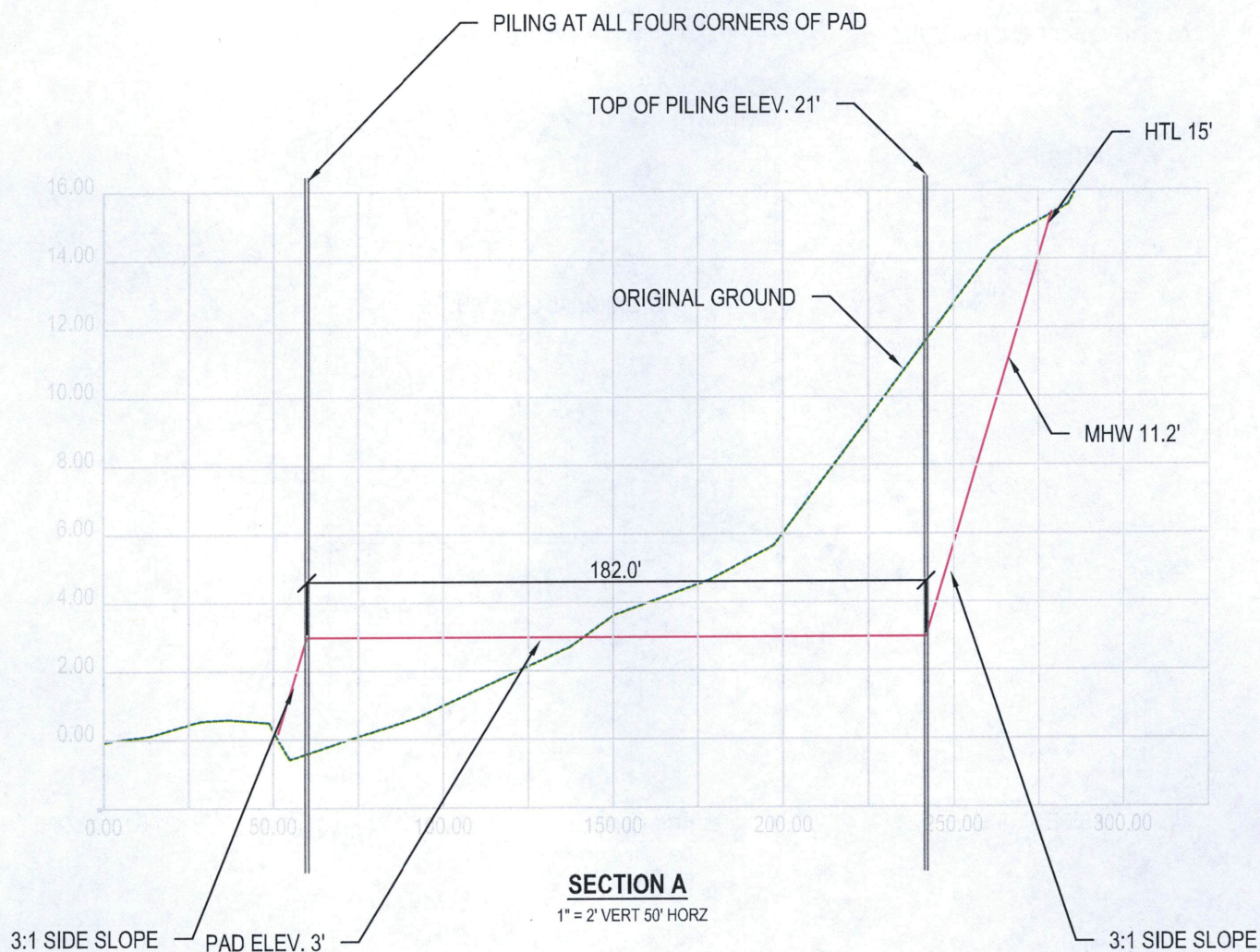

TIDAL INFORMATION

WATER LEVEL	ELEVATION
EST. MAX HIGH WATER	17.05
MHHW	12.14
MHW	11.21
MLW	1.51
MLLW	0.00
EST. MAX LOW WATER	-5.45

ABOVE INFO PROVIDED BY NOAA TIDAL DATUM 9/30/2011

CITY: VALDEZ BOROUGH: N/A STATE: ALASKA
 DIRECTIONS: FROM INTERSECTION OF AIRPORT ROAD
 AND RICHARDSON HIGHWAY APPROXIMATELY 3.7
 MILES FROM VALDEZ POST OFFICE. GO SOUTHWEST
 ON MINERAL CREEK LOOP ROAD 0.4 MILES ACCESS IS
 VIA OLD DOCK ACROSS FROM VFDA OR OLD VALDEZ
 DOCK AREA.

APPLICANT: VALDEZ FISHERIES DEVELOPMENT ASSOC
 FILE NO.: POA-2016-537
 WATERWAY: PORT VALDEZ
 PROPOSED ACTIVITY: NEW NET PEN STORAGE
 SEC. 3, T. 9 S., R. 6 W., COPPER RIVER MERIDIAN
 LAT.: N 61°07'13" LONG.: W 146°16'47" NAD 83
 SHEET 5 OF 7 DATE: 1/5/17

PIILING AT ALL FOUR CORNERS OF PAD

TOP OF PILING ELEV. 21'

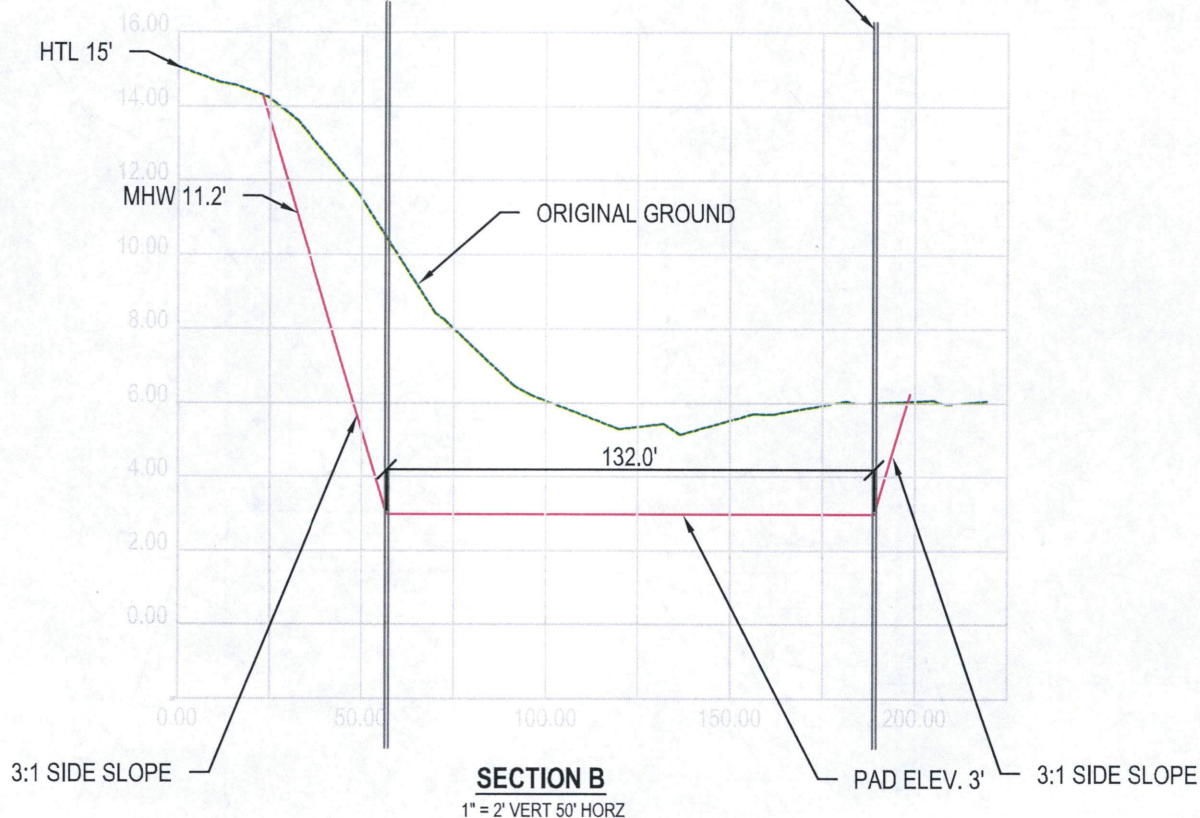

TIDAL INFORMATION

WATER LEVEL	ELEVATION
EST. MAX HIGH WATER	17.05
MHHW	12.14
MHW	11.21
MLW	1.51
MLLW	0.00
EST. MAX LOW WATER	-5.45

ABOVE INFO PROVIDED BY NOAA TIDAL DATUM 9/30/2011

CITY: VALDEZ BOROUGH: N/A STATE: ALASKA
 DIRECTIONS: FROM INTERSECTION OF AIRPORT ROAD
 AND RICHARDSON HIGHWAY APPROXIMATELY 3.7
 MILES FROM VALDEZ POST OFFICE. GO SOUTHWEST
 ON MINERAL CREEK LOOP ROAD 0.4 MILES ACCESS IS
 VIA OLD DOCK ACROSS FROM VFDA OR OLD VALDEZ
 DOCK AREA.

APPLICANT: VALDEZ FISHERIES DEVELOPMENT ASSOC
 FILE NO.: POA-2016-537
 WATERWAY: PORT VALDEZ
 PROPOSED ACTIVITY: NEW NET PEN STORAGE
 SEC. 3, T. 9 S., R. 6 W., COPPER RIVER MERIDIAN
 LAT.: N 61°07'13" LONG.: W 146°16'47" NAD 83
 SHEET 6 OF 7 DATE: 1/5/17

CONSTRUCTION NOTES:

1. ALL MATERIAL USED FOR FILL WILL BE FROM THE EXCAVATION ABOVE ELEVATION 3.
2. DREDGING WILL BE ABOVE THE ELEVATION 3.
3. FOUR 18 INCH STEEL PILING WILL BE SET AT THE FOUR CORNERS OF THE PAD. VIBRATORY DRIVING MEANS OF SETTING THE PILE.
4. NO STORM WATER POLLUTION AND PREVENTION PLAN IS REQUIRED. IMPACT AREA LESS THAN 1 ACRE.
5. AS PART OF THIS PROJECT THE REMOVAL AND DISPOSAL OF AN OLD GROUNDED BARGE WILL TAKE PLACE IMPROVING THE AREA.

GENERAL NOTES:

1. STEEL PILING WILL BE USED TO SECURE THE FISH PENS.

ALTERNATIVE SITE NOTES:

1. THE SELECTED AREA HAS A VERY LOW IMPACT TO THE SURROUNDING WATERS OF THE U.S.
2. THIS AREA HAS HAD PREVIOUS FILLS TO THE NORTHWEST, EAST AND SOUTHEAST.
3. THE PURPOSE OF THIS PROJECT IS TO PROTECT THE EXPAND THE STORAGE CAPACITY OF NET FISH PENS THAT ARE BEING USED TO ENHANCE THE FISHERIES.
4. EXISTING NET FISH PEN SITE WILL CONTINUE TO BE USED.
5. NO OTHER SITE NEARBY HAS THE PROTECT THAT THIS SITE AFFORDS WITH THE PROTECTION THAT THE OLD DOCK TO THE NORTHWEST PROVIDES.
6. AREA TO SOUTH IS THE EMERGENCY BARGE LANDING AREA.

CITY: VALDEZ BOROUGH: N/A STATE: ALASKA
DIRECTIONS: FROM INTERSECTION OF AIRPORT ROAD
AND RICHARDSON HIGHWAY APPROXIMATELY 3.7
MILES FROM VALDEZ POST OFFICE. GO SOUTHWEST
ON MINERAL CREEK LOOP ROAD 0.4 MILES ACCESS IS
VIA OLD DOCK ACROSS FROM VFDA OR OLD VALDEZ
DOCK AREA.

APPLICANT: VALDEZ FISHERIES DEVELOPMENT ASSOC
FILE NO.: POA-2016-537
WATERWAY: PORT VALDEZ
PROPOSED ACTIVITY: NEW NET PEN STORAGE
SEC. 3, T. 9 S., R. 6 W., COPPER RIVER MERIDIAN
LAT.: N 61°07'13" LONG.: W 146°16'47" NAD 83
SHEET 7 OF 7 DATE: 1/5/17